

LINGENFELTER

PERFORMANCE ENGINEERING

2015 Product Brochure

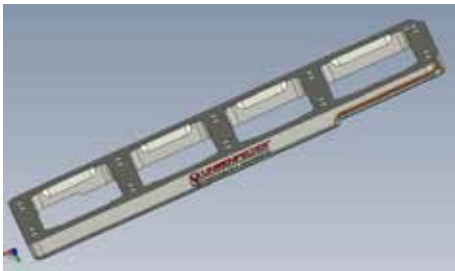
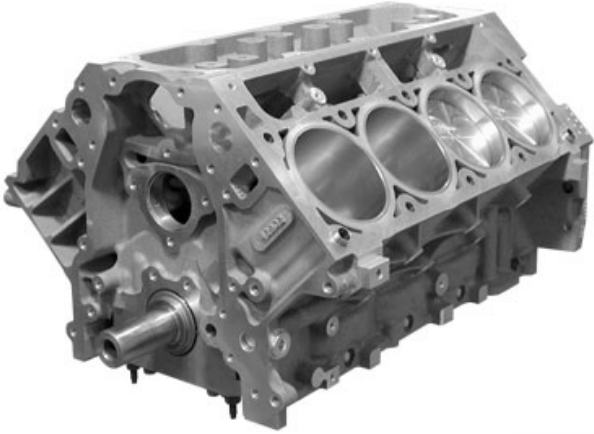

Lingenfelter Performance Engineering
1557 Winchester Road
Decatur, IN 46733
(260) 724-2552
(260) 724-8761 fax
www.lingenfelter.com

Thank you for your interest in Lingenfelter Performance Engineering (LPE) products.

For customer service or technical help questions, please call (260) 724-2552, Monday–Friday, 8:00 a.m. – 5:00 p.m. (EST), Saturday 8:00 a.m. – 12:00 p.m. (EST). E-mails can be submitted at any time by contacting sales@lingenfelter.com or by emailing your particular sales person.

Orders can be placed via phone, fax, email or online via the LPE web store.

International orders are welcome. Exports to countries outside of the USA will be via money wire transfer or Paypal® with authorized address only. No credit cards will be accepted without prior authorization and address verification.



Lingenfelter Performance Engineering
1557 Winchester Road
Decatur, IN 46733
(260) 724-2552
(260) 724-8761 fax
www.lingenfelter.com

Disclaimer: All product, product specifications, package, package specifications and data are subject to change without notice. LPE is not responsible for typographical errors.

Company Overview

Founding and leadership

For more than 40 years, Lingenfelter Performance Engineering (LPE) has been a globally recognized brand in the performance engineering industry. The company offers installed high performance engine packages; crate engines; engine, chassis and other automotive components; product development services; prototype and production product testing; late product life-cycle performance improvements; durability testing; and show and media event vehicle preparation.

Lingenfelter Performance Engineering was founded by John Lingenfelter, a legend in the world of performance engineering and racing. John's racing career spanned more than four decades where he raced everything from Super Stock and Comp door cars to Econo dragsters, Pro Stock Trucks and Sport Compact. John was the first Comp driver to break the six-second quarter-mile barrier. In his career, he won 13 NHRA national event titles – nine in Comp, three in Super Stock and one in Pro Stock Truck. In early 2002, John took on a new challenge: sport compact racing. In just a few months, he won one national event and had two runner-up finishes. In October 2002, at the Mazda NHRA Sport Compact World Finals in Pomona, California, John lost control of his vehicle and sustained serious injuries in the accident. He passed away as a result of complications from subsequent surgeries on December 25, 2003, at the age of 58.

Today, Lingenfelter Performance Engineering continues to build on the Lingenfelter tradition under the leadership of Ken Lingenfelter, a distant relative of John's. As CEO, Ken is committed to investing in the technology, research, design and testing necessary to continue to target design excellence in engine packages and aftermarket components. An avid automotive enthusiast, Ken is also the owner of The Lingenfelter Collection – an ever-changing compilation of historically significant race cars, muscle cars, Corvettes and exotic cars. With the company's full line of innovative products, talented employees and worldwide customer base, the Lingenfelter legend remains intact in every detail and is reflected in every Lingenfelter Performance Engineering vehicle through unrivaled power, speed and control.

Engines

Lingenfelter Performance Engineering is committed to producing high-performing, high-quality engines and is one of the only builders in the industry to offer a 3-year/36,000-mile warranty standard on installed engine packages. These include LS1, LS2, LS3, LS6, LS7, LSA, LS9, LT1, LT4 & LT5 engine packages that are naturally aspirated, turbocharged or supercharged. Lingenfelter Performance Engineering has engine packages for most GM late model V8 engine equipped vehicles including: Corvette, Camaro, Firebird, GTO, G8, CTS-V, SSR, Trailblazer SS, Escalade, H2, Yukon, Tahoe, Suburban, Silverado & Sierra.

Private Label Products

Lingenfelter Performance Engineering offers private label product development and testing for automotive engine and electronics components. LPE also offers private label programs for many of the existing LPE products for companies and resellers that want an individually branded version of these products.

Armored and Protective Services Products

Lingenfelter Performance Engineering offers products and engineering services for the armored vehicle and protective services industry. Products include powertrain upgrades to bring vehicle performance back to or closer to pre-armor levels, suspension components, cooling system components and HVAC system upgrades.

Lingenfelter Engineering Services

Lingenfelter Performance Engineering offers automotive, marine engine and engine component product development and testing services to aftermarket and original equipment suppliers and manufacturers. The company provides the following services:

- o Show vehicle preparation
- o Engine assembly and custom engine builds
- o Racing engines
- o Crate engines
- o Cylinder head assembly
- o Cylinder head porting either by hand or by CNC (5 axis CNC)
- o Cylinder head port development
- o Air flow bench testing
- o Engine dynamometer testing from our two (2) engine dynamometer cells
- o Chassis dynamometer testing from our two (2) chassis dynamometer cells
- o Fuel flow and water pump flow testing
- o 2D & 3D CAD part design (SolidWorks)
- o Digitizing/reverse engineering (Faro arm, laser scanner and Renishaw touch probe on CNC)
- o Fabrication, welding and machining services

Lingenfelter Performance Engineering can also provide low volume engine and engine component manufacturing and assembly. The company offers CNC porting of cylinder heads, assembly of cylinder heads and crate motor engine assembly. Lingenfelter Performance Engineering also boasts cylinder head port development services and can CNC port cylinder heads using a customer supplied sample port design or math data or can develop a port design that meets the customer requirements. The company performs CNC porting of aluminum and iron cylinder heads and intake manifolds.

Lingenfelter Performance Engineering has the capability to provide prototype and preparation of vehicles for product development, late product life-cycle performance improvements, durability testing, show vehicles and media event vehicles.

A fully computerized time clock system allows Lingenfelter Performance Engineering to track the labor associated with any particular project or job, enabling the company to provide customers with detailed billing and cost analysis.

Aftermarket Components

Lingenfelter Performance Engineering takes its same legendary focus of creating the world's highest performing engine and applies it to a full line of automotive performance parts. Some of the products available with the Lingenfelter Performance Engineering brand include:

- o Air Intakes
- o Body Components
- o Cooling System Related Components
- o Drivetrain Components
- o Electronics & Electrical Parts
- o Engine Components
- o Exhaust Systems and Components
- o Fuel Systems and Components
- o Short Blocks and Crate Engines
- o Suspension Components
- o Tools

Table Of Contents

| | Page # |
|--|---------------|
| New Lingenfelter Products for 2015 | 5 |
| 2010-2015 5th Gen Camaro Products..... | 6-7 |
| 2012-2015 ZL1 Camaro Products | 8-9 |
| 1997-2004 C5 Corvette Products | 10 |
| 2005-2013 C6 Corvette Products | 11-12 |
| 2009-2013 C6 ZR1 Corvette Products | 13 |
| 2014-2015 C7 Corvette Products | 14-15 |
| 2009-2015 CTS-V Products | 16-17 |
| GM Truck Products (Escalade, Suburban, Tahoe, Yukon, H2, Trailblazer SS...) | 18 |
| 2014-2015 Silverado & Sierra and 2015 GM SUV Products | 19 |
| Lingenfelter Precision Built Engine Assemblies | 20-28 |
| 550 HP 6.2L naturally aspired LT1 heads & cam package..... | 21 |
| 550 HP 6.2L naturally aspired LS3 crate engine | 22 |
| 650 HP 6.2L supercharged LS3 crate engine | 23 |
| 605 HP 417 CID naturally aspired LS3 crate engine..... | 24 |
| 700 HP 417 CID supercharged LS3 crate engine | 25 |
| 650 HP 427 CID naturally aspired LS7 crate engine..... | 26 |
| 750 HP 427 CID supercharged LS7 crate engine | 27 |
| 900 HP 378 CID supercharged LSA crate engine | 28 |
| LS & LT Engine Related Components (GM Gen III, IV & V V8) | 29 |
| Miscellaneous Engine Related Products & Tools | 30 |
| Camshafts And Related Products..... | 31 |
| Supercharger System Related Products | 32-33 |
| Air Intake Kits | 34 |
| Fuel System Related Products | 35 |
| Electronic Products..... | 36 |
| 5-Axis CNC Head Porting Services | 37 |
| Miscellaneous Products..... | 38 |
| Thermostats..... | 39 |
| GM Car Thermostat Chart..... | 40 |
| GM Truck Thermostat Chart..... | 41 |
| Chrysler, Dodge, Ford & Jeep Thermostats | 41 |
| Cooling System Related Products..... | 42-43 |
| LS9 Pulley Combinations Chart..... | 44 |
| LSA Pulley Combinations Chart | 45 |
| NOTES page | 46 |

New Lingenfelter Products for 2015



| Description | Part Number |
|---|--------------|
| LPE single sided belt conversion kit, 2014-2015 C7 Corvette, pulleys only | L330045414 |
| LPE single sided belt conversion kit, 2014-2015 C7 Corvette, w pump | L330055414 |
| 160 degree thermostat, GM Gen V V8 & V6 engines (LT1, L86, L83, LV1, LV3) | L310166914 |
| 170 degree thermostat, GM Gen V V8 & V6 engines (LT1, L86, L83, LV1, LV3) | L310176914 |
| 180 degree thermostat, GM Gen V V8 & V6 engines (LT1, L86, L83, LV1, LV3) | L310186914 |
| LNC-2014 RPM limiter/launch controller w timing retard function for Gen V V8 | L460306914 |
| C7 Corvette 0.250" Front Subframe Spacer Kit | L510070114 |
| GT30 Gen V V8 (LT1, L86, L83) camshaft, 217/229 w 576/576 LSA 116, AFM compatible | L210306914 |
| GT31 Gen V V8 (LT1, L86, L83) camshaft, 217/245 w 635/661 LSA 121 | L210316914 |
| GT32 Gen V V8 (LT1, L86, L83) camshaft, 225/241 w 643/657 LSA 114 | L210326914 |
| GT34 Gen V V8 (LT1, L86, L83) camshaft, 229/233 w 646/650 LSA 118 | L210346914 |
| LPE GM Gen V V8 camshaft phaser delete kit (LT1, L86, L83 engines) | L200326914 |
| C7 Corvette intercooler manifold | L260060114 |
| CNC port LT1 & L86 GM Gen V V8 DI cylinder head, each (head not included) | L160377114 |
| C6 Z06 aluminum radiator | XX05930-0001 |
| 550 HP C7 Corvette heads & cam kit, 2014-2015 MY | L280040114 |
| LSx series engine high volume oil pump kit, standard pressure | L200315297 |
| STOV-003 SPEED ACTIVATED SWITCH AND SPEED TO VDC CONV, KIT | L460270000 |
| VFSM-001 variable speed fan & pump temperature controller | L460320000 |
| C6 driver side regulator plug with jet supply orifice fitting, black | L760080103 |
| Fuel line T-fitting with check valve assembly (3/8" I/O) | L760100000 |

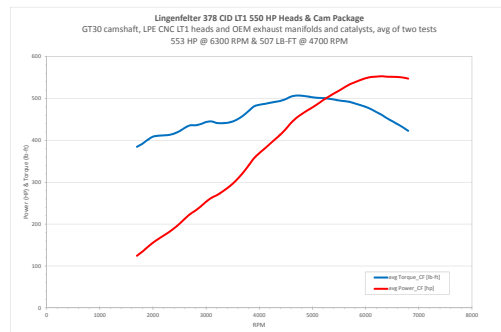

2010-2015 5th Gen Camaro Products



5th Gen Camaro Engine and Performance Packages

| Description | Part Number |
|--|-------------|
| LS3 417 CID short block engine, 58x, 9.75 compression | L110335306 |
| LS3 417 CID short block engine, 58x, 11.5 compression | L110345306 |
| LS7 427 CID short block engine, 58x, 9.75 compression | L110235306 |
| LS7 427 CID short block engine, 58x, 11.5 compression | L110245306 |
| LS3 378 CID crate engine, 58x, 11.5 compression, 550 HP | L130215306 |
| LS3 378 CID crate engine, 58x, 11.5 compression, 575 HP | L130225306 |
| LS3 378 CID supercharged crate engine, 58x, 9.75 compression, 650 HP | L130235306 |
| LS3 417 CID crate engine, 58x, 11.5 compression, 605 HP | L130245306 |
| LS3 417 CID supercharged crate engine, 58x, 9.75 compression, 700 HP | L130255306 |
| LS7 427 CID crate engine, 58x, 11.5 compression, 650 HP | L130265306 |
| LS7 427 CID supercharged crate engine, 58x, 9.75 compression, 750 HP | L130275306 |

Other 5th Gen Camaro Products

| Description | Part Number |
|---|-------------|
| Thermostat, 160 degree, CK truck/Trailblazer '07-13, LS3/L99/LSA/LS9 '09-13 | L310065307 |
| Thermostat, 174 degree, CK truck/Trailblazer '07-13, LS3/L99/LSA/LS9 '09-13 | L310155307 |
| Gen 5 Camaro intercooler radiator and fan kit | L320042012 |
| VariMax intercooler pump w bracket and connector kit | TAFX410110 |
| 2010-2015 Camaro Fuel Pump Voltage Booster Kit | L460111410 |
| Twin fuel pump kit, electronic control | L710071410 |
| Twin fuel pump kit, for external mechanical regulator | L710081410 |
| 6 bolt LS9 twin-disk clutch kit | L360020105 |
| LS9 clutch kit spacer for 2010-2015 Camaro | L360031410 |
| 8 bolt flywheel for LS9 clutch (for LSA and 454 LSX crate engine conversions) | L360066509 |
| Camaro SS clutch pedal return kit 2010-2014 | L360091410 |
| 2010-2013 Camaro shift knob boot adapter kit | L350191410 |
| CTAP-001 Clutch and Throttle Activation Position switch | L460190108 |
| 2010-2014 Camaro SS pedals, black with LPE logo, wide gas pedal, MT | L820011410 |
| 2010-2014 Camaro SS pedals, black w. LPE logo, standard gas pedal kit MT | L820021410 |
| 2010-2014 Camaro SS pedals, black with LPE logo, standard gas pedal kit AT | L820031410 |

2010-2015 5th Gen Camaro Products (continued)

| Description | Part Number |
|--|-------------|
| Camaro 10 rib accessory drive kit, 7.33 damper | L220251410 |
| Camaro 10 rib accessory drive kit, 7.8 damper | L220261410 |
| Camaro 10 rib accessory drive kit, 8.0 damper | L220271410 |
| LS9 supercharger drive wet sump damper kit, OEM diameter | L220396197 |
| LS9 supercharger drive wet sump damper kit, 14% overdrive | L220406197 |
| Camaro SS & CK truck LS7 dry sump balancer kit, 10% underdrive | L220575299 |
| HD 5th Gen Camaro SS power steering pump kit, standard volume | L220431410 |
| HD 5th Gen Camaro SS power steering pump kit, racing volume | L220441410 |
| 6 rib pulley for HD Camaro SS power steering pumps | L220371410 |
| 10 rib pulley for HD Camaro SS power steering pumps | L220421410 |
| 2010-2013 Camaro SS water pump with 10 rib water pump pulley | L330021410 |
| Gen 5 Camaro rear suspension, adjustable trailing arm, pair | L500101410 |
| Gen 5 Camaro rear suspension link, adjustable forward tie rod, pair | L500111410 |
| Gen 5 Camaro rear suspension adjustable stabilizer bar end link, pair | L500121410 |
| Camaro Drag Race Suspension Shock and Spring Kit | L500151410 |
| 3.70 ring and pinion, 218 mm differential (Camaro SS) | L380011410 |
| 3.91 ring and pinion, 218 mm differential (Camaro SS) | L380211410 |
| 218 mm differential ring and pinion install kit | AAM74010007 |
| 9.5" differential, empty case | L380051410 |
| 9.5" differential, 3.42 ratio, W PRELOAD | L380061410 |
| 9.5" differential, 3.42 ratio, NO PRELOAD | L380071410 |
| 9.5" differential, 3.73 ratio, W PRELOAD | L380081410 |
| 9.5" differential, 3.73 ratio, NO PRELOAD | L380091410 |
| 9.5" differential, 4.10 ratio, W PRELOAD | L380101410 |
| 9.5" differential, 4.10 ratio, NO PRELOAD | L380111410 |
| 9.5" differential, 4.56 ratio, W PRELOAD | L380121410 |
| 9.5" differential, 4.56 ratio, NO PRELOAD | L380131410 |
| HD LPE 2-piece driveshaft, MT, 9.5" differential, Camaro SS | L390031410 |
| HD LPE 2-piece driveshaft, AT, 9.5" differential, Camaro SS | L390041410 |
| HD halfshafts for 9.5" differential, set | L390111410 |
| Lingenfelter Signature Series Ram Air High Rise Camaro Hood | L850131410 |
| Lingenfelter Signature Series Front Chin Spoiler Camaro SS | L850141410 |
| Lingenfelter Signature Series Rear Deck Spoiler Camaro | L850151410 |
| Lingenfelter Signature Series Rear Valance Camaro SS | L850161410 |
| Lingenfelter Signature Series Rocker Covers Camaro SS | L850171410 |
| Lingenfelter Signature Series Front Grill With Insert Fiberglass | L850181410 |
| Lingenfelter Signature Series Front Grill With Carbon Fiber Insert | L850191410 |
| Lingenfelter Signature Series Ram Air Camaro Hood With Window | L850201410 |
| GTZ Camaro Extractor Hood | SWS10501001 |
| HD carbon fiber jackshaft for Magnuson SC kits, 18.168" center to center, 2010-2015 Camaro SS <i>(other custom order lengths also available)</i> | L250481817 |

2012-2015 Chevrolet ZL1 Camaro Products



ZL1 Camaro ZL1 Engine and Performance Packages

| Description | Part Number |
|---|-------------|
| LPE 630 horsepower Camaro ZL1 package | L250356512 |
| LPE 650 horsepower Camaro ZL1 package | L250366512 |
| LPE 700+ horsepower Camaro ZL1 package | L250376512 |
| LSA 378 CID 3.6L Twin Screw supercharged crate engine, 58x, 8.9:1, 900 HP | CALL |

Other ZL1 Camaro Products

| Description | Part Number |
|---|-------------|
| 2.55" supercharger pulley, LSA, one piece | L220030709 |
| 2.55" 2 piece LSA pulley, 8 rib, 10 bolt (10 bolt hub kit required) | L220300709 |
| 2.38" 2 piece LSA pulley, 8 rib, 10 bolt (10 bolt hub kit required) | L220310709 |
| Solid supercharger isolator coupling, LSA & LS9 | L960202012 |
| 10 bolt SC pulley hub and bolt kit | L250150309 |
| LSA 10 bolt hub 2.55" pulley kit | L250466509 |
| LSA damper kit (SC pulley required) | L220050709 |
| Stock diameter LSA damper pulley, 7.87", for LSA damper kit | L220646509 |
| 6% overdrive LSA damper pulley, 8.25", for LSA damper kit | L220060709 |
| 11% overdrive LSA damper pulley, 8.66", for LSA damper kit | L220070709 |
| 18% overdrive LSA damper pulley, 9.17", for LSA damper kit | L220170709 |
| 23% overdrive LSA damper pulley, 9.55", for LSA damper kit | L220290709 |
| 28% overdrive LSA damper pulley, 10.0", for LSA damper kit | L220380709 |
| 10 rib LSA damper pulley, 9.73", for LSA damper kit | L220450709 |
| LSA 10 rib tensioner pulley (for LSA 10 rib conversions) | L220620709 |
| Idler pulley relocation bracket kit (for 9.55", 9.73" & 10.0" SC drive pulleys) | L200636509 |
| 76 mm double bearing idler pulley kit, 8 to 11 rib | L250120309 |
| 90 mm double bearing idler pulley kit, 8 to 11 rib | L250260090 |
| 100 mm double bearing idler pulley kit, 8 to 11 rib | L250130309 |
| Thermostat, 160 degree, CK truck/Trailblazer '07-13, LS3/L99/LSA/LS9 '09-13 | L310065307 |
| Thermostat, 174 degree, CK truck/Trailblazer '07-13, LS3/L99/LSA/LS9 '09-13 | L310155307 |

Chevrolet ZL1 Camaro Products (continued)

| Description | Part Number |
|--|--------------------|
| High flow LS9 LSA injector, 62 lbs/hr, 668 cc/min, angled spray | L730100309 |
| Bosch Motorsports 980 cc/min injectors, short, USCar connector | BOS0280158040 |
| 2010-2015 Camaro Fuel Pump Voltage Booster Kit | L460111410 |
| GT9 LS series camshaft, 215/247 .629/.656 HR121 | L210150309 |
| GT22 LS series camshaft, 228/232 346/350 R118 | L210170106 |
| LSA to TVS2300 LS9 supercharger conversion front cover | L250406509 |
| LSA forged 4.070" piston assembly (for aftermarket connecting rod) | L290016509 |
| Camaro SS/ZL1 intercooler radiator and fan kit | L320042012 |
| ZL1 intercooler reservoir kit (LPE air intake required) | L300152012 |
| ZL1 air intake duct kit (for stock air box) | L650172012 |
| Low restriction ZL1 air intake kit (no ECU calibration needed) | L650182012 |
| ZL1 shock tower brace, black w/ Lingenfelter logo | L500182012 |
| Ported OEM LSA front cover with 10 bolt hub | L250456512 |
| Ported OEM LSA front cover with pressed on 2.55" pulley | L250446512 |
| Lingenfelter liquid to air intercooler manifold - LS3, LSA and LS9 heads | L260045307 |
| CTAP-001 Clutch and Throttle Activation Position switch | L460190108 |
| CTAP-001 to Camaro, Corvette & CTS-V clutch position sensor PNP harness | L480370108 |
| LS3, LS2, LS7, LSA, LS9 throttle body ext harness w TPS signal wire output | CE105454 |
| 1655mm / 65.2" 8 rib belt | 8PK1655 |
| 1643mm / 64.5" 8 rib belt | K080645 |
| 1702mm / 67.0" 8 rib belt | K080670 |
| 1715mm / 67.5" 8 rib belt | K080675 |
| 1727mm / 68.0" 8 rib belt | K080680 |
| 1742mm / 68.5" 8 rib belt | K080685 |
| 1775mm / 70.0" 8 rib belt | K080700 |

**Refer to the belt fitment chart on page 45 for a list of available
LPE LSA pulley and damper combinations.**

1997-2004 C5 Corvette Products



C5 Corvette Engine and Performance Packages

| Description | Part Number |
|---|-------------|
| 346 LS1 11.5:1 CR, 24x crank, H-beam rods Short Block Engine Assembly | L110125297 |
| 383 LS1 11.5:1 CR, 24x crank, H-beam rods Short Block Engine Assembly | L110045297 |
| Gen IV V8 LS2 403 CID short block engine, 24x, 9.75 compression* | L110075305 |
| Gen IV V8 LS2 403 CID short block engine, 24x, 11.5 compression* | L110085305 |

*Gen IV based engines will require adapter harnesses and other components to convert from Gen III to IV sensor locations etc.

Other C5 Corvette Products

| Description | Part Number |
|--|-------------|
| Thermostat, 160, LS1/LS6, 1997-2004 | L310045297 |
| Thermostat, 180, LS1/LS6, 1997-2004 | L310035297 |
| THERMOSTAT, 160, LS1/LS6, 1997-2004, NO HOUSING | L310145297 |
| High flow C5 fuel pump kit, 1997-2003 | L710650197 |
| Corvette C5 & C6 front & C6 rear leaf spring height adjuster (not C5 rear) | L500010197 |
| Corvette clutch pedal return kit, C5 & C6 1997-2013 | L360080197 |
| 90 mm C5 Corvette (1997-2004) & CTS-V (2004-2005) throttle body | L270010197 |
| Mechanical turbocharger scavenge pump, C5 & C6 offset | L200240197 |
| Lingenfelter liquid to air intercooler manifold - LS1, LS6 and LS2 heads | L260035297 |
| C5 Corvette Battery Relocation Kit, Lightweight | L450010197 |
| C5 Corvette Battery Relocation Kit, Standard | L450020197 |
| C5 & C6 Corvette stainless steel front subframe spacer kit, 0.250" | L510050197 |
| C5 Corvette High Rise Supercharger Hood | L850060197 |
| C5 & C6 Corvette pedals, black with LPE logo, wide gas pedal, MT | L820040197 |
| C5 & C6 Corvette pedals, black with LPE logo, standard gas pedal, AT | L820050197 |
| C5 & C6 Corvette pedals, black with LPE logo, standard gas pedal, MT | L820140197 |
| C5 Edelbrock E-Force supercharger install kit | L250280197 |
| C5 E-Force coil cover kit, blank | L810180197 |
| C5 intercooler reservoir kit | L300165297 |
| C5 throttle body bypass kit | L300145297 |
| C5 oil pressure sensor relocation kit | L960215297 |

2005-2013 C6 Corvette Products



C6 Corvette Engine and Performance Packages

| Description | Part Number |
|--|-------------|
| LS2 366 CID short block engine, 24x, 9.75 compression | L110055305 |
| LS2 366 CID short block engine, 24x, 11.5 compression | L110065305 |
| LS2 403 CID short block engine, 24x, 9.75 compression | L110075305 |
| LS2 403 CID short block engine, 24x, 11.5 compression | L110085305 |
| LS3 417 CID short block engine, 58x, 9.75 compression | L110335306 |
| LS3 417 CID short block engine, 58x, 11.5 compression | L110345306 |
| LS7 427 CID short block engine, 58x, 9.75 compression | L110235306 |
| LS7 427 CID short block engine, 58x, 11.5 compression | L110245306 |
| LS3 378 CID crate engine, 58x, 11.5 compression, 550 HP | L130215306 |
| LS3 378 CID crate engine, 58x, 11.5 compression, 575 HP | L130225306 |
| LS3 378 CID supercharged crate engine, 58x, 9.75 compression, 650 HP | L130235306 |
| LS3 417 CID crate engine, 58x, 11.5 compression, 605 HP | L130245306 |
| LS3 417 CID supercharged crate engine, 58x, 9.75 compression, 700 HP | L130255306 |
| LS7 427 CID crate engine, 58x, 11.5 compression, 650 HP | L130265306 |
| LS7 427 CID supercharged crate engine, 58x, 9.75 compression, 750 HP | L130275306 |
| LPE 616 HP C6 ZO6 Corvette engine kit | L280016006 |
| LPE 630 HP C6 ZO6 Corvette engine kit | L280016008 |
| LPE 660 HP C6 ZO6 Corvette engine kit | L280016007 |

Other C6 Corvette Products

| Description | Part Number |
|--|-------------|
| Thermostat, 160 degree, CK truck/Trailblazer '07-13, LS3/L99/LSA/LS9 '09-13 | L310065307 |
| Thermostat, 174 degree, CK truck/Trailblazer '07-13, LS3/L99/LSA/LS9 '09-13 | L310155307 |
| Thermostat, 160, LS2/LS7, 2004-2008 | L310015204 |
| Thermostat, 180, LS2/LS7, 2004-2008 | L310055204 |
| C6 Z06 LS7 air intake kit, 2006-2013 | L650090206 |
| C6 LS2 air intake kit, 2005-2007 | L650070105 |
| LPE 2005-2013 C6 Corvette air intake replacement filter (for LPE air intake kit) | L660070105 |

Other C6 Corvette Products (continued)

| Description | Part Number |
|---|--------------|
| C6 ZR1 style radiator for Z06 Corvette - allows conversion to ZR1 style liquid to air oil cooler (provides intercooler clearance for supercharged & turbo applications) | XX05930-0001 |
| VariMax intercooler pump w bracket and connector kit | TAFX410110 |
| Bosch to VariMax intercooler pump adapter harness | L480340000 |
| High flow E85 compatible C6 fuel pump module, internal regulator, '05-'06 MY | L710120105 |
| High flow E85 compatible C6 fuel pump module, internal regulator, '07-'13 MY | L710130106 |
| Corvette clutch pedal return kit, C5 & C6 Corvette, 1997-2013 | L360080197 |
| CTAP-001 Clutch and Throttle Activation Position switch | L460190108 |
| CTAP-001 to Camaro, Corvette & CTS-V clutch position sensor PNP harness | L480370108 |
| Throttle body extension harness w TPS signal wire output | CE105454 |
| 6 bolt flywheel LS9 clutch kit for all C6 Corvettes (except ZR1) | L360020105 |
| C5 & C6 Corvette pedals, black with LPE logo, wide gas pedal, MT | L820040197 |
| C5 & C6 Corvette pedals, black with LPE logo, standard gas pedal, AT | L820050197 |
| C5 & C6 Corvette pedals, black with LPE logo, standard gas pedal, MT | L820140197 |
| C6 Corvette Passenger Side Fuel Pressure Regulator Bypass Plug, RED | L750000103 |
| C6 Corvette Driver Side Fuel Pressure Regulator Bypass Plug, BLUE | L750010103 |
| C6 Corvette driver side fuel pump module regulator plug with jet supply orifice | L760080103 |
| Mechanical turbocharger scavenge pump, C5 & C6 Offset | L200240197 |
| Lingenfelter liquid to air intercooler manifold - LS1, LS6 and LS2 heads | L260035297 |
| Lingenfelter liquid to air intercooler manifold - LS3, LSA and LS9 heads | L260045307 |
| Corvette C5 & C6 front & C6 rear leaf spring height adjuster (not C5 rear) | L500010197 |
| LS9 wet sump damper kit, OEM diameter | L220396197 |
| LS9 wet sump damper kit, 14% overdrive | L220406197 |
| C5 & C6 Corvette stainless steel front subframe spacer kit, 0.250" | L510050197 |
| Lingenfelter C6 Twin Turbo Commemorative Corvette Hood | L850010105 |
| Lingenfelter C6 Twin Turbo Commemorative Corvette Rear Fascia | L850030105 |
| Lingenfelter C6 Twin Turbo Commemorative Corvette Chin Spoiler | L850040105 |
| Lingenfelter C6 Twin Turbo Commemorative Corvette Side Skirts | L850050105 |
| C6 Corvette SV2 Supercharger Hood | L850070105 |
| C6 Corvette SV3 Supercharger Hood - smooth no scoop design | L850080105 |
| C6 Corvette SV4 Supercharger Hood | L850090105 |
| C6 Corvette SV4 Supercharger Hood, Clear View Window | L850100105 |
| C6 Corvette SV5 Smooth Supercharger Hood | L850120105 |

2009-2013 Corvette ZR1 Products



C6 ZR1 Corvette Engine and Performance Packages

| Description | Part Number |
|-----------------------------------|-------------|
| LPE 680 HP ZR1 Engine Package Kit | |
| LPE 710 HP ZR1 Engine Package Kit | L250346109 |
| LPE 750 HP ZR1 Engine Package Kit | L250336109 |

See chart on page 44 for LS9 pulley and damper combinations.

Other C6 ZR1 Corvette Products

| Description | Part Number |
|---|---------------|
| Thermostat, 160 degree, CK truck/Trailblazer '07-13, LS3/L99/LSA/LS9 '09-13 | L310065307 |
| Thermostat, 174 degree, CK truck/Trailblazer '07-13, LS3/L99/LSA/LS9 '09-13 | L310155307 |
| ZR1 2.6 supercharger pulley kit, LS9 engine, 2009-2013 | L250090309 |
| ZR1 Corvette LS9 14% overdrive damper kit, 2009-2013 | L220100309 |
| 2.60" 11 rib LS9 pulley, one piece | L220040309 |
| 10 bolt SC pulley hub and bolt kit | L250150309 |
| 2.38" 11 rib LS9 10 bolt pulley (10 bolt hub required) | L220136109 |
| 2.60" 11 rib LS9 10 bolt pulley (10 bolt hub required) | L220146109 |
| LPE LS9 supercharger front cover (LPE pulleys and air intake required) | L250110309 |
| ZR1 Corvette air intake (for LPE LS9 front cover) | L650150309 |
| Throttle body extension harness w TPS signal wire output | CE105454 |
| GT9 LS series camshaft, 215/247 .629/.656 HR121 | L210150309 |
| GT22 LS series camshaft, 228/232 346/350 R118 | L210170106 |
| Corvette clutch pedal return kit, C5 & C6 1997-2013 | L360080197 |
| LS9 9 bolt billet steel flywheel | L360040309 |
| High flow LS9 LSA injector, 62 lbs/hr, 668 cc/min, angled spray | L730100309 |
| Bosch Motorsports 980 cc/min injectors, short, USCar connector | BOS0280158040 |
| LS9 double valve spring retainer kit | XX04190-0016 |
| Solid supercharger isolator coupling, LSA & LS9 | L960202012 |
| 76 mm double bearing idler pulley kit, 8 to 11 rib | L250120309 |
| 90 mm double bearing idler pulley kit, 8 to 11 rib | L250260090 |
| 100 mm double bearing idler pulley kit, 8 to 11 rib | L250130309 |
| LNC-2001 2-step and timing retard controller (for LSA & LS9 applications) | L460216509 |

2014 C7 Corvette Products



2014-2015 C7 Corvette Engine and Performance Packages

| Description | Part Number |
|--|-------------|
| 417 CID LT1/L86 engine with forged pistons, wet sump | |
| 417 CID LT1/L86 engine with forged pistons, dry sump | |
| LPE 2014 C7 Corvette Eforce LT1 Supercharger Kit, Wet Sump (non Z51) | L250495414 |
| LPE 2014 C7 Corvette Eforce LT1 Supercharger Kit, Dry Sump (Z51) | L250505414 |
| 550 HP heads and cam package | |

Other C7 Corvette Related Products

| Description | Part Number |
|---|-------------|
| 160 degree thermostat, GM Gen V V8 & V6 engines (LT1, L86, L83, LV1, LV3) | L310166914 |
| 170 degree thermostat, GM Gen V V8 & V6 engines (LT1, L86, L83, LV1, LV3) | L310176914 |
| 180 degree thermostat, GM Gen V V8 & V6 engines (LT1, L86, L83, LV1, LV3) | L310186914 |
| LPE single sided belt conversion kit, 2014-2015 C7 Corvette, pulleys only | L330045414 |
| LPE single sided belt conversion kit, 2014-2015 C7 Corvette, w pump | L330055414 |
| C7 Corvette 0.250" Front Subframe Spacer Kit | L510070114 |
| C7 Corvette intercooler manifold | L260060114 |
| Gen V V8 AFM compatible camshaft, LT1/L86/L83, 222/234 .318/.294 R118 | L210186914 |
| GT30 Gen V V8 (LT1, L86, L83) camshaft, 217/229 w 576/576 LSA 116, AFM compatible | L210306914 |
| GT31 Gen V V8 (LT1, L86, L83) camshaft, 217/245 w 635/661 LSA 121 | L210316914 |
| GT32 Gen V V8 (LT1, L86, L83) camshaft, 225/241 w 643/657 LSA 114 | L210326914 |
| GT34 Gen V V8 (LT1, L86, L83) camshaft, 229/233 w 646/650 LSA 118 | L210346914 |
| LPE GM Gen V V8 camshaft phaser delete kit (LT1, L86, L83 engines) | L200326914 |
| CNC port LT1 & L86 GM Gen V V8 DI cylinder head, each (head not included) | L160377114 |
| LNC-2014 RPM limiter/launch controller w timing retard function for Gen V V8 | L460306914 |
| CAN2-002 4 ch CAN to analog gauge driver and relay output module | L460260704 |
| RPM-003 RPM activated switch with window switch mode & TPS/Clutch Input | L460160000 |
| CTAP-001 Clutch and Throttle Activation Position switch | L460190108 |

Other C7 Corvette Related Products (continued)

| Description | Part Number |
|--|-------------|
| CTAP-001 to Camaro, Corvette & CTS-V clutch position sensor PNP harness | L480370108 |
| NCC-002 nitrous controller kit with harnesses & sensors (for EFI applications) | L460200000 |
| C7 Corvette torsional vibration damper, LT1 dry sump engine, stock OD, SFI | |
| C7 Corvette torsional vibration damper, LT1 wet sump engine, stock OD, SFI | |



2009-2015 Cadillac CTS-V Products



2009-2015 Cadillac CTS-V Engine and Performance Packages

| Description | Part Number |
|---|-------------|
| LPE 630 HP 2009-2015 Cadillac CTS-V engine package kit | L250310709 |
| LPE 650 HP 2009-2015 Cadillac CTS-V supercharger upgrade kit | L250300709 |
| LPE 700+ HP 2009-2015 Cadillac CTS-V supercharger upgrade kit | L250326509 |
| LSA 378 CID 3.6L Twin Screw supercharged crate engine, 58x, 8.9:1, 900 HP | CALL |

Other 2009-2015 Cadillac CTS-V Products

| Description | Part Number |
|---|-------------|
| Thermostat, 160 degree, CK truck/Trailblazer '07-13, LS3/L99/LSA/LS9 '09-13 | L310065307 |
| Thermostat, 174 degree, CK truck/Trailblazer '07-13, LS3/L99/LSA/LS9 '09-13 | L310155307 |
| CTS-V air inlet tube kit (for stock air box) | L650140709 |
| CTS-V supercharger pulley kit, LSA engine | L250070709 |
| 2.55" Cadillac CTS-V pulley, LSA, one piece | L220030709 |
| 2.55" 2 piece LSA pulley, 8 rib, 10 bolt (10 bolt hub kit required) | L220300709 |
| 2.38" 2 piece LSA pulley, 8 rib, 10 bolt (10 bolt hub kit required) | L220310709 |
| 10 bolt SC pulley hub and bolt kit | L250150309 |
| LSA 10 bolt hub 2.55" pulley kit | L250466509 |
| Solid supercharger isolator coupling, LSA & LS9 | L960202012 |
| LSA CTS-V damper kit (SC pulley required) | L220050709 |
| Stock diameter LSA damper pulley, 7.87". for LSA damper kit | L220646509 |
| 6% overdrive LSA damper pulley, 8.25", for LSA damper kit | L220060709 |
| 11% overdrive LSA damper pulley, 8.66", for LSA damper kit | L220070709 |
| 18% overdrive LSA damper pulley, 9.17", for LSA damper kit | L220170709 |
| 23% overdrive LSA damper pulley, 9.55", for LSA damper kit | L220290709 |
| 28% overdrive LSA damper pulley, 10.0", for LSA damper kit | L220380709 |
| 10 rib LSA damper pulley, 9.73" | L220450709 |
| LSA 10 rib tensioner pulley (for LSA 10 rib conversions) | L220620709 |
| 2009-2015 CTS-V and 2010-2015 Camaro SS clutch pedal return kit | L360091410 |

2009-2015 Cadillac CTS-V Products (continued)

| Description | Part Number |
|--|---------------|
| GT9 LS series camshaft, 215/247 .629/.656 HR121 | L210150309 |
| GT22 LS series camshaft, 228/232 346/350 R118 | L210170106 |
| LSA to LS9 TVS2300 supercharger conversion front cover | L250406509 |
| Ported OEM LSA front cover with 10 bolt hub | L250456512 |
| Ported OEM LSA front cover with pressed on 2.55 pulley | L250446512 |
| LSA forged 4.070" piston assembly (for aftermarket connecting rod) | L290016509 |
| LSA idler pulley relocation bracket kit | L220636509 |
| CTS-V intercooler radiator and fan kit (includes PS cooler kit) | L320030709 |
| CTS-V power steering cooler kit, 2009-2015 | L320050709 |
| CTS-V intercooler pump upgrade kit (VariMax pump + CTS-V harness) | L330030709 |
| CTS-V shock tower brace, black w/ Lingenfelter logo, 2009-2014 | L500130709 |
| 2009-2014 CTS-V pedals, black with LPE logo, wide gas pedal, MT | L820110709 |
| 2009-2014 CTS-V pedals, black with LPE logo, standard gas pedal, MT | L820120709 |
| 2009-2014 CTS-V pedals, black with LPE logo, standard gas pedal, AT | L820130709 |
| 2009-2014 Cadillac CTS-V fuel pump module regulator block off relief valve | XX03547-0010 |
| High flow LS9 LSA injector, 62 lbs/hr, 668 cc/min, angled spray | L730100309 |
| Bosch Motorsports 980 cc/min injectors, short, USCar connector | BOS0280158040 |
| Lingenfelter liquid to air intercooler manifold - LS3, LSA and LS9 heads | L260045307 |
| Throttle body extension harness w TPS signal wire output | CE105454 |
| 76 mm double bearing idler pulley kit, 8 to 11 rib | L250120309 |
| 90 mm double bearing idler pulley kit, 8 to 11 rib | L250260090 |
| 100 mm double bearing idler pulley kit, 8 to 11 rib | L250130309 |
| 1655mm / 65.2" 8 rib belt | 8PK1655 |
| 1643mm / 64.5" 8 rib belt | K080645 |
| 1702mm / 67.0" 8 rib belt | K080670 |
| 1715mm / 67.5" 8 rib belt | K080675 |
| 1727mm / 68.0" 8 rib belt | K080680 |
| 1742mm / 68.5" 8 rib belt | K080685 |
| 1775mm / 70.0" 8 rib belt | K080700 |

**Refer to the belt fitment chart on page 45 for a list of available
LPE LSA pulley and damper combinations.**

Silverado, Sierra, Suburban, Tahoe & Other GM Truck Products



CK & ST Truck Engine and Performance Packages

| Description | Part Number |
|---|-------------|
| 366 CID short block engine, 24x, 9.75 compression, aluminum block | L110055305 |
| 366 CID short block engine, 24x, 11.5 compression, aluminum block | L110065305 |
| 403 CID short block engine, 24x, 9.75 compression, aluminum block | L110075305 |
| 403 CID short block engine, 24x, 11.5 compression, aluminum block | L110085305 |
| 417 CID short block engine, 58x, 9.75 compression, aluminum block | L110335306 |
| 417 CID short block engine, 58x, 11.5 compression, aluminum block | L110345306 |
| TVS1900 & TVS2300 supercharger packages | CALL |

Other CK & ST Truck Products

| Description | Part Number |
|--|-------------|
| Thermostat, 160, LS1/LS6, 1997-2004 | L310045297 |
| Thermostat, 180, LS1/LS6, 1997-2004 | L310035297 |
| Thermostat, 160, LS2/LS7, 2004-2008 | L310015204 |
| Thermostat, 180, LS2/LS7, 2004-2008 | L310055204 |
| Thermostat, 160 degree, CK truck/Trailblazer '07-13, LS3/L99/LSA/LS9 '09-13 | L310065307 |
| Thermostat, 174 degree, CK truck/Trailblazer '07-13, LS3/L99/LSA/LS9 '09-13 | L310155307 |
| CK truck 10 rib accessory drive kit, 7.3" damper | L220510607 |
| CK truck 10 rib accessory drive kit, 7.8" damper | L220520607 |
| CK truck 10 rib accessory drive kit, 8.0" damper | L220530607 |
| 2500 Suburban & Yukon XL, 4WD, front anti-sway bar, 2007-2013, 38 mm | HW8396 |
| 2500 Suburban & Yukon XL, 4WD, rear anti-sway bar, 2007-2013, 32 mm | HW8397 |
| CK truck HO aux fan kit, ECM control | L300130607 |
| Low boost TVS1900 supercharger system for armored 2007-2013 2500 Suburbans. Includes LS2 throttle, LS7/LSA spark plugs, high output ECM controlled auxilliary fans & 160 amp alternator. | L250140607 |
| 2007-2013 CK truck auxilliary fan kit, AC control | L300080607 |
| 2007-2013 CK truck auxilliary fan kit, ECM control | L300090607 |
| Trailblazer and SSR High Flow Fuel Pump Kit, 2005-2009 | L710111005 |
| 2007 Suburban and Yukon XL 2500 series fuel pump upgrade kit | L710050607 |

2014-2015 Silverado & Sierra & 2015 SUV Products



CK Truck Engine and Performance Packages

| Description | Part Number |
|--|-------------|
| 417 CID LT1/L86 engine with forged pistons, wet sump | |
| Magnuson TVS1900 supercharger system, 5.3L L83 | |
| Magnuson TVS1900 supercharger system, 6.2L L86 | |

Other 2014-2015 CK Truck Products

| Description | Part Number |
|---|-------------|
| 160 degree thermostat, GM Gen V V8 & V6 engines (LT1, L86, L83, LV1, LV3) | L310166914 |
| 170 degree thermostat, GM Gen V V8 & V6 engines (LT1, L86, L83, LV1, LV3) | L310176914 |
| 180 degree thermostat, GM Gen V V8 & V6 engines (LT1, L86, L83, LV1, LV3) | L310186914 |
| Liquid to air intercooler manifold, w. secondary inj provisions - LT1, L86 & L83 | L260056914 |
| Gen V V8 AFM compatible camshaft, LT1/L86/L83, 222/234 .318/.294 R118 | L210186914 |
| GT30 Gen V V8 (LT1, L86, L83) camshaft, 217/229 w 576/576 LSA 116, AFM compatible | L210306914 |
| GT31 Gen V V8 (LT1, L86, L83) camshaft, 217/245 w 635/661 LSA 121 | L210316914 |
| GT32 Gen V V8 (LT1, L86, L83) camshaft, 225/241 w 643/657 LSA 114 | L210326914 |
| GT34 Gen V V8 (LT1, L86, L83) camshaft, 229/233 w 646/650 LSA 118 | L210346914 |
| LPE GM Gen V V8 camshaft phaser delete kit (LT1, L86, L83 engines) | L200326914 |
| CNC port LT1 & L86 GM Gen V V8 DI cylinder head, each (head not included) | L160377114 |
| LNC-2014 RPM limiter/launch controller w timing retard function for Gen V V8 | L460306914 |
| CAN2-002 4 ch CAN to analog gauge driver and relay output module | L460260704 |
| RPM-003 RPM activated switch with window switch mode & TPS/Clutch Input | L460160000 |
| CTAP-001 Clutch and Throttle Activation Position switch | L460190108 |
| CTAP-001 to Camaro, Corvette & CTS-V clutch position sensor PNP harness | L480370108 |
| NCC-002 nitrous controller kit with harnesses & sensors (for EFI applications) | L460200000 |

Lingenfelter Precision Built Engine Assemblies

Lingenfelter Precision built custom engine assemblies for street and race applications can be ordered with many additional components and features. You can select specific options to make your engine assembly exactly as you need it. Here is a brief summary of some of the engine combinations available from LPE.

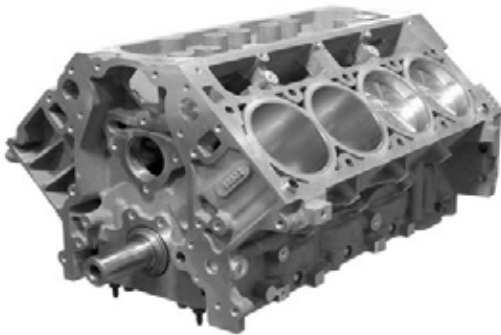

| Description | Part Number |
|---|-------------|
| 346 LS1 11.5:1 CR, 24x crank, H-beam rods Short Block Engine Assembly | L110125297 |
| 383 LS1 11.5:1 CR, 24x crank, H-beam rods Short Block Engine Assembly | L110045297 |
| LS2 366 CID short block engine, 24x, 9.75 compression | L110055305 |
| LS2 366 CID short block engine, 24x, 11.5 compression | L110065305 |
| LS2 403 CID short block engine, 24x, 9.75 compression | L110075305 |
| LS2 403 CID short block engine, 24x, 11.5 compression | L110085305 |
| LS3 417 CID short block engine, 58x, 9.75 compression | L110335306 |
| LS3 417 CID short block engine, 58x, 11.5 compression | L110345306 |
| LS7 427 CID short block engine, 58x, 9.75 compression | L110235306 |
| LS7 427 CID short block engine, 58x, 11.5 compression | L110245306 |
| LS3 378 CID crate engine, 58x, 11.5 compression, 550 HP | L130215306 |
| LS3 378 CID crate engine, 58x, 11.5 compression, 575 HP | L130225306 |
| LS3 378 CID supercharged crate engine, 58x, 9.75 compression, 650 HP | L130235306 |
| LS3 417 CID crate engine, 58x, 11.5 compression, 605 HP | L130245306 |
| LS3 417 CID supercharged crate engine, 58x, 9.75 compression, 700 HP | L130255306 |
| LS7 427 CID crate engine, 58x, 11.5 compression, 650 HP | L130265306 |
| LS7 427 CID supercharged crate engine, 58x, 9.75 compression, 750 HP | L130275306 |
| LSA 378 CID 3.6L Twin Screw supercharged crate engine, 58x, 8.9:1, 900 HP | CALL |

Lingenfelter 550 HP C7 Corvette LT1 Heads & Cam Kit (378 CID)

11.5:1 compression ratio 93 octane fuel

(uses customer LT1 engine or LT1 crate engine)

- Lingenfelter GT30 camshaft (L210306914)
- Comp Cams cam phaser limiter kit
- Lingenfelter CNC porting of cylinder heads (intake runner, exhaust runner, chamber)
- Multi-angle valve seat machining, hand blending of valve seats and expert cylinder head assembly
- Lingenfelter double valve spring kit with titanium retainers (L230075897)
- Surfacing of cylinder heads to achieve desired compression ratio
- Multi-layer steel (MLS) cylinder head gaskets
- GM head bolts, crank bolt
- Correct length high strength pushrods

NOTE - power level shown also included port matching of the OEM intake manifold, ported throttle body and low restriction air filter element.

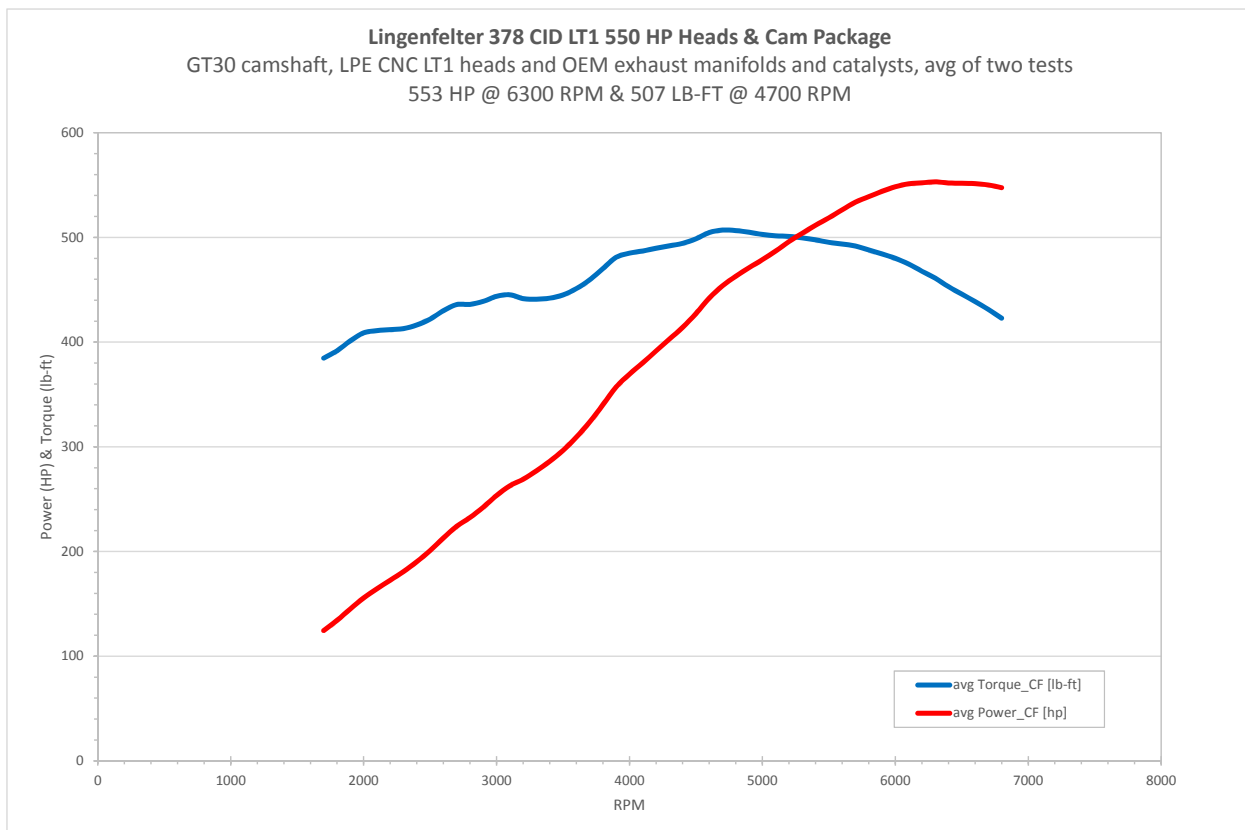

Lingenfelter LS3 6.2 L 550 HP

11.5:1 compression ratio 93 octane fuel

- GM LS3 6.2 L aluminum block
- GM LS3 connecting rods
- GM LS3 steel crankshaft
- GM LS3 pistons
- Lingenfelter LS 3 bolt cam conversion kit (L200175307)
- GM crank gear & HD timing chain
- Lingenfelter GT11 hydraulic roller camshaft (L210065297)
- GM LS3 oil pump
- ATI underdrive balancer
- GM LS3 lifters, lifter guides
- C6 Corvette aluminum oil pan
- C6 Corvette valley cover, valve covers
- C6 Corvette rear cover
- Multi-layer steel (MLS) cylinder head gaskets
- GM head bolts, crank bolt
- Lingenfelter CNC ported & polished LS3 cylinder heads
- LPE LSx double valve spring kit with titanium retainers, seals, locks & spring seats (L230075897)
- GM hollow stem 2.165 intake valves
- GM 1.59 exhaust valves
- Competition Cams HD pushrods
- 1.8 ratio LS3 roller rocker arms (intake & exhaust)
- LS3 Corvette composite intake manifold, port matched with OEM LS3 fuel rails
- 90 mm throttle body, electronic, ported [*mechanical throttle also available*]
- 42 lbs/hr at 58 psi (4.0 bar) fuel injectors
- LS3 coils
- Magnecor spark plug wires
- LPE logo Koolsox wire protectors
- LS9 iridium spark plugs
- Lingenfelter Precision Built Engine certificate of authenticity

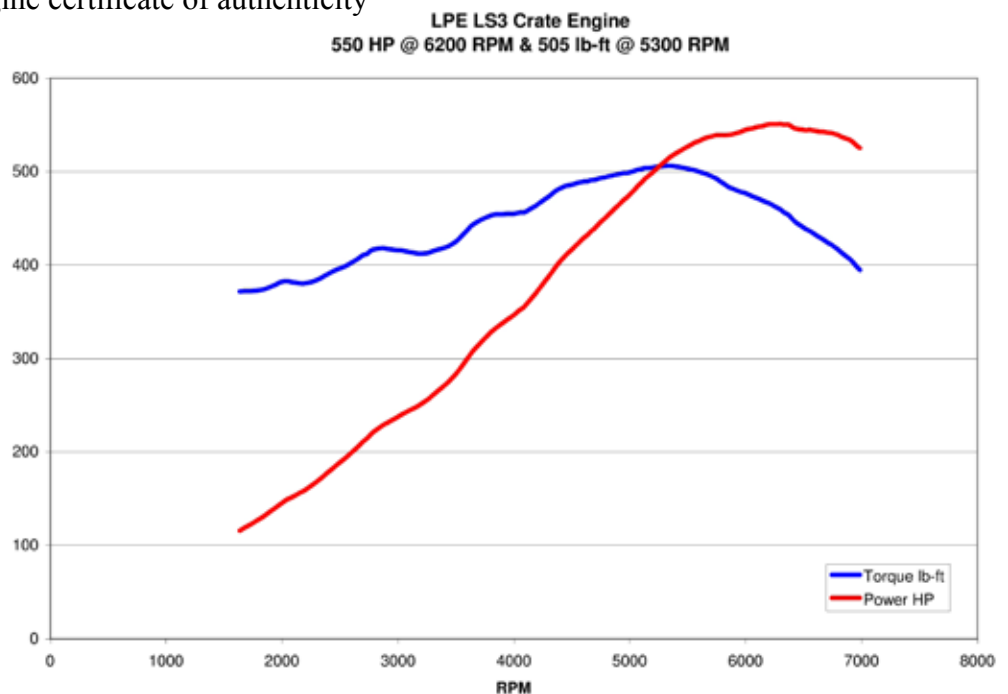

As tested configuration includes the following components (not included): LS3 water pump, Turn One P/S pump, 1-7/8" long tube headers, LS3 Camaro oil pan, 4" MAF

Lingenfelter Supercharged LS3 6.2 L 650 HP

9.7:1 compression ratio 93 octane fuel

- GM LS3 6.2 L aluminum block
- Oliver 6.125 4340 billet steel I-Beam connecting rods
- GM LS3 steel crankshaft
- Clevite heavy duty rod & main bearings
- JE forged aluminum pistons
- Total Seal File Fit Premium rings
- Lingenfelter LS 3 bolt cam conversion kit (L200175307)
- GM crank gear & HD timing chain
- Lingenfelter GT9 hydraulic roller camshaft (L210150309)
- GM LS3 oil pump
- GM keyed harmonic balancer
- GM LS3 lifters, lifter guides
- C6 Corvette aluminum oil pan
- C6 Corvette valley cover, valve covers
- C6 Corvette rear cover
- Multi-layer steel (MLS) cylinder head gaskets
- GM head bolts, crank bolt
- Lingenfelter CNC ported & polished LS3 cylinder heads
- LPE LSx double valve spring kit with titanium retainers, seals, locks & spring seats (L230075897)
- GM 2.165 hollow stem intake valves
- GM 1.59 Inconel exhaust valves
- Competition Cams HD pushrods
- GM LS3 roller rocker arms, rocker arm stands, bolts
- Magnuson TVS2300 supercharger system – black finish
- 90 mm throttle body, electronic
- Properly sized fuel injectors
- LS3 coils
- Magnecor spark plug wires
- LPE logo Koolsox wire protectors
- LS9 iridium spark plugs
- Lingenfelter Precision Built Engine certificate of authenticity



Lingenfelter LS3 417 CID 605 HP

11.5:1 compression ratio 93 octane fuel

- GM LS3 6.2 L aluminum block
- Oliver 6.125 4340 billet steel I-Beam connecting rods
- Callies 4340 Forged steel DS crankshaft – 4.000” stroke
- Clevite heavy duty rod & main bearings
- JE forged aluminum pistons
- Total Seal File Fit Premium rings
- Lingenfelter LS 3 bolt cam conversion kit (L200175307)
- GM crank gear & HD timing chain
- Lingenfelter GT series hydraulic roller camshaft
- LSx series engine high volume oil pump kit (L200315297)
- GM keyed harmonic balancer
- GM LS3 lifters, lifter guides
- C6 Corvette aluminum oil pan
- C6 Corvette valley cover, valve covers
- C6 Corvette rear cover
- Multi-layer steel (MLS) cylinder head gaskets
- GM head bolts, crank bolt
- Lingenfelter CNC ported & polished LS3 cylinder heads
- LPE LSx double valve spring kit with titanium retainers, seals, locks & spring seats (L230075897)
- GM 2.165 hollow stem intake valves
- GM 1.59 exhaust valves
- Competition Cams HD pushrods
- LS3 roller rocker arms
- GM rocker arm stands, bolts
- LS3 Corvette composite intake manifold - fuel rails
- 90 mm throttle body, electronic
- 42 lbs/hr at 58 psi (4.0 bar) fuel injectors
- LS3 coils
- Magnecor spark plug wires
- LPE logo Koolsox wire protectors
- LS9 iridium spark plugs
- Lingenfelter Precision Built Engine certificate of authenticity

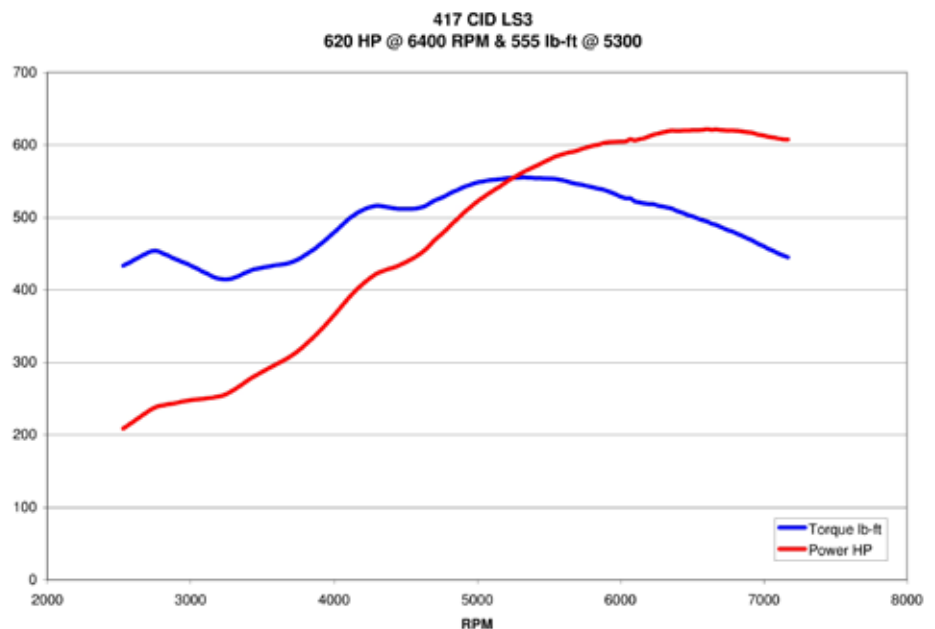

417 CID LS3 with optional dry sump oil pump and pan..

Lingenfelter Supercharged LS3 417 CID 700 HP

9.7:1 compression ratio 93 octane fuel

- GM LS3 6.2 L aluminum block
- Oliver 6.125 4340 billet steel I-beam connecting rods
- Callies 4340 forged steel DS crankshaft – 4.000” stroke
- Clevite heavy duty rod & main bearings
- JE forged aluminum pistons
- Total Seal File Fit Premium rings
- Lingenfelter LS 3 bolt cam conversion kit (L200175307)
- GM crank gear & HD timing chain
- Lingenfelter GT9 hydraulic roller camshaft (L210150309)
- LSx series engine high volume oil pump kit (L200315297)
- GM keyed harmonic balancer
- GM LS3 lifters, lifter guides
- C6 Corvette aluminum oil pan
- C6 Corvette valley cover, valve covers
- C6 Corvette rear cover
- Multi-layer steel (MLS) cylinder head gaskets
- GM head bolts, crank bolt
- Lingenfelter CNC ported & polished LS3 cylinder heads
- LPE LSx double valve spring kit with titanium retainers, seals, locks & spring seats (L230075897)
- GM 2.165 hollow stem intake valves
- GM 1.59 Inconel exhaust valves
- Competition Cams HD pushrods
- GM LS3 roller rocker arms, rocker arm stands, bolts
- Magnuson TVS2300 supercharger system – black finish
- 90 mm throttle body, electronic
- 70 lbs/hr at 58 psi (4 bar) fuel injectors
- LS3 coils
- Magnecor spark plug wires
- LPE logo Koolsox wire protectors
- LS9 iridium spark plugs
- Lingenfelter Precision Built Engine certificate of authenticity



*Optional equipment shown.

Lingenfelter LS7 427 CID 650 HP

11.5:1 compression ratio 93 octane fuel

- GM LS7 7 L aluminum block
- Oliver 6.125 4340 billet steel I-beam connecting rods
- Callies 4340 forged steel DS crankshaft – 4.000” stroke
- Clevite heavy duty rod & main bearings
- JE forged aluminum pistons
- Total Seal File Fit Premium rings
- Lingenfelter LS 3 bolt cam conversion kit (L200175307)
- GM crank gear & HD timing chain
- Lingenfelter GT21 hydraulic roller camshaft (L210146006)
- GM LS7 dry sump oil pump
- GM keyed harmonic balancer
- GM LS7 lifters, lifter guides
- Corvette LS7 dry sump aluminum oil pan
- C6 Corvette valley cover, valve covers
- C6 Corvette rear cover
- Multi-layer steel (MLS) cylinder head gaskets
- GM head bolts, crank bolt
- Lingenfelter CNC ported & polished LS7 cylinder heads
- LPE Ferrea double valve spring kit (L230036006)
- GM LS7 2.205 diameter titanium intake valves
- GM LS7 1.615 diameter hollow stemmed sodium filled exhaust valves
- Competition Cams HD pushrods
- GM LS7 roller rocker arms, rocker arm stands, bolts
- LS7 Corvette composite intake manifold - fuel rails
- 90 mm throttle body, electronic
- 50 lbs/hr at 58 psi (4 bar) fuel injectors
- LS7 coils
- Magnecor spark plug wires
- LPE logo Koolsox wire protectors
- LS9 iridium spark plugs
- Lingenfelter Precision Built Engine certificate of authenticity

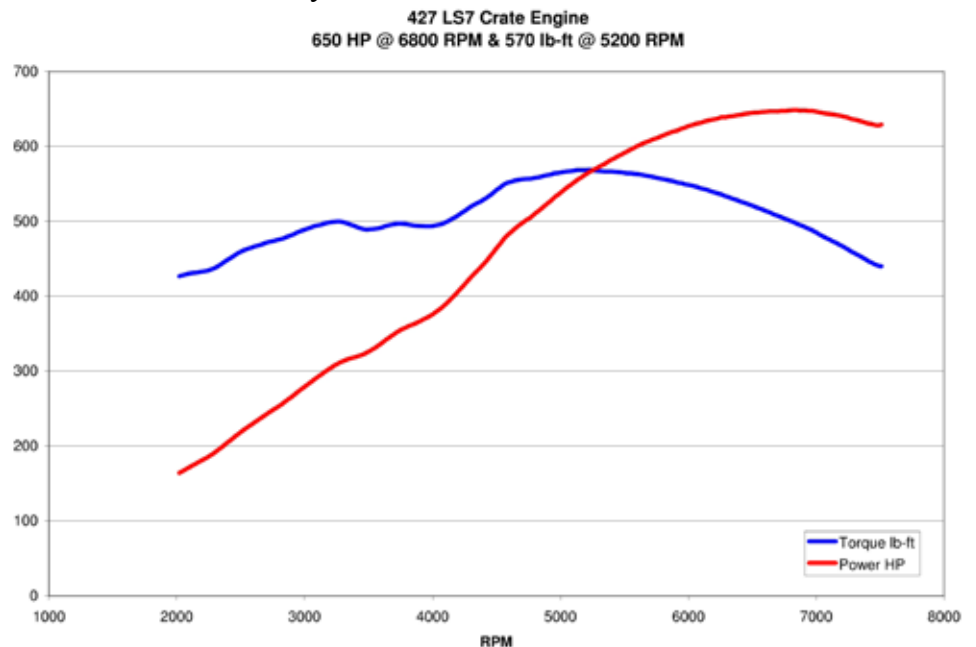

Lingenfelter LS7 Supercharged 427 CID 750 HP

9.7:1 compression ratio 93 octane fuel

- GM LS7 7 L aluminum block
- Oliver 6.125 4340 billet steel I-Beam connecting rods
- Callies 4340 Forged steel DS crankshaft – 4.000” stroke
- Clevite heavy duty rod & main bearings
- JE forged aluminum pistons
- Total Seal File Fit Premium rings
- Lingenfelter LS 3 bolt cam conversion kit (L200175307)
- GM crank gear & HD timing chain
- Lingenfelter GT9 hydraulic roller camshaft (L210150309)
- LSx series engine high volume oil pump kit (L200315297)
- ATI 10 rib keyed harmonic balancer
- GM LS7 lifters, lifter guides
- C6 Corvette aluminum oil pan
- C6 Corvette valley cover, valve covers
- C6 Corvette rear cover
- Multi-layer steel (MLS) cylinder head gaskets
- GM head bolts, crank bolt
- Lingenfelter CNC ported & polished LS7 cylinder heads
- LPE LSx double valve spring kit with titanium retainers, seals, locks & spring seats (L230075897)
- GM LS7 2.205 diameter titanium intake valves
- GM LS7 1.615 diameter hollow stemmed sodium filled exhaust valves
- Competition Cams HD pushrods
- GM LS7 roller rocker arms, rocker arm stands, bolts
- Magnuson TVS2300 supercharger system – black finish
- Lingenfelter 10 rib front accessory drive kit
- Lingenfelter 14 rib rear supercharger drive system
- 90 mm throttle body, electronic
- 70 lbs/hr at 58 psi (4 bar) fuel injectors
- LS7 coils
- Magnecor spark plug wires
- LPE logo Koolsox wire protectors
- LS9 iridium spark plugs
- Lingenfelter Precision Built Engine certificate of authenticity



*Optional equipment shown.

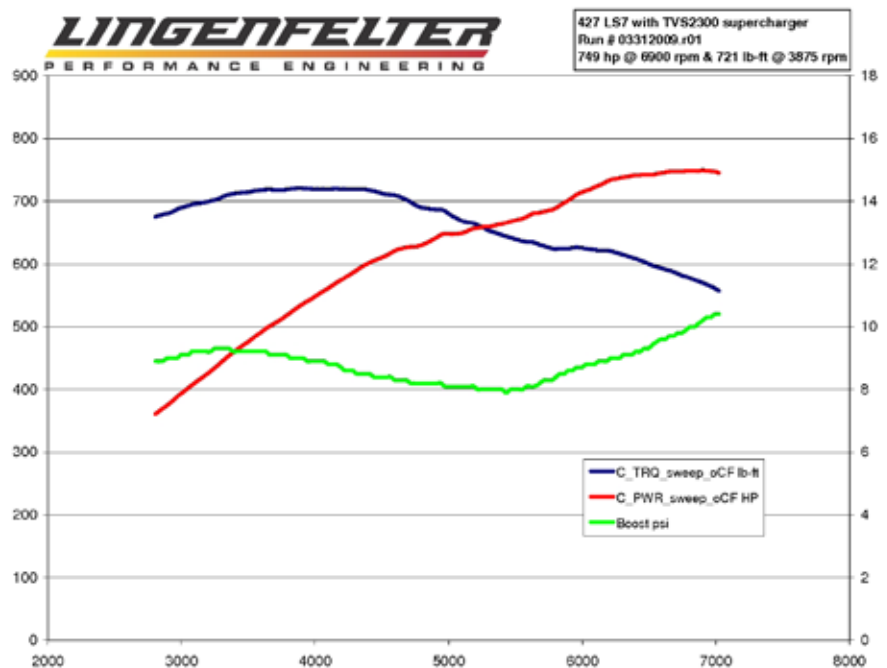

Lingenfelter LSA or LS9 3.6L Twin Screw Supercharged 378 CID 900 HP

8.9:1 compression ratio

- GM LSA 6.2L aluminum block (*customer may upgrade to LS9 block if using LS9 cylinder heads*)
- LPE LSA 4.070 forged piston kit, PN L290016509
- OEM piston oil cooling jets
- LPE CNC ported LSA cylinder heads with hollow stem LS3 intake valves and Inconel exhaust valves (*customer can also upgrade to LS9 heads with titanium intake valves if desired*)
- LPE LSx double valve spring kit with titanium retainers, seals, locks & spring seats (L230075897)
- GM LSA/LS9 multi-layer steel head gasket
- 6.125 4340 connecting rods
- 3.622" stroke forged steel crankshaft, wet sump (*customer may upgrade to dry sump crank*)
- Lingenfelter LS 3 bolt cam conversion kit PN L200175307
- GM crank gear & HD timing chain
- Lingenfelter GT22 hydraulic roller camshaft PN L210170106
- LSx series engine high volume oil pump kit PN L200315297 (*or dry sump pump if customer so chooses*)
- LPE/ATI LSA damper with 8.66 SC drive pulley
- GM lifters, lifter guides
- LSA aluminum oil pan
- Valley cover, valve covers, rear timing cover
- GM head bolts, crank bolt
- HD pushrods
- GM roller rocker arms, rocker arm stands, bolts
- Kenne Bell 3.6L supercharger system
- 90 mm throttle body, electronic
- Bosch Motorsports 980 cc/min injectors, PN BOS0280158040
- LSA valve covers & coils
- Magnecor spark plug wires
- LPE logo Koolsox wire protectors
- 1-7/8" headers
- LS9 iridium spark plugs (*customer may substitute Denso IT24 or IT27 spark plugs depending on usage*)
- Lingenfelter Precision Built Engine certificate of authenticity

Recommended options:

- EMP-Stewart intercooler pump w. LPE 25 amp high flow calibration
- High capacity intercooler radiator (LPE CTS-V or Camaro)
- High capacity intercooler reservoir
- High output fuel supply system

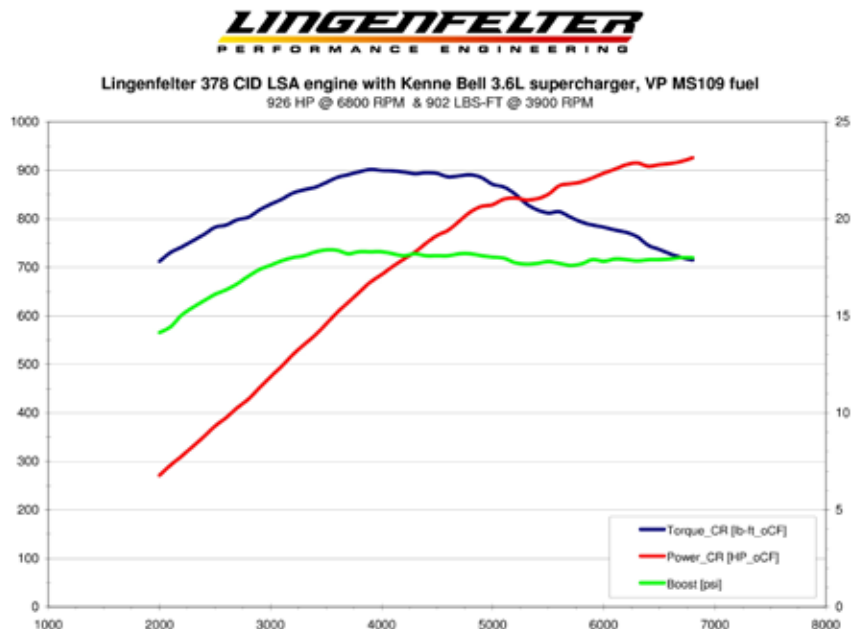

LS & LT Engine Related Components (GM Gen III, IV & V V8)

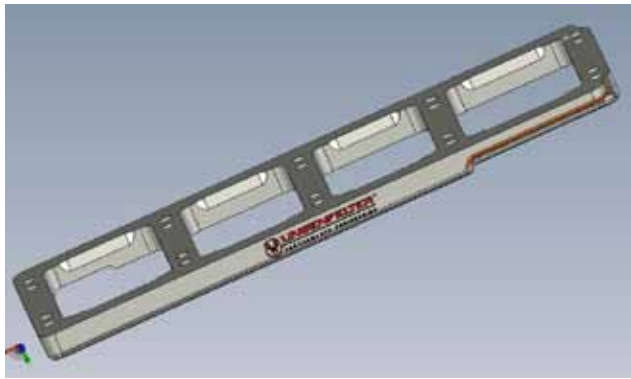

| Description | Part Number |
|--|----------------|
| LSA forged 4.070" piston assembly (for aftermarket connecting rod) | L290016509 |
| LS 3 bolt cam conversion kit | L200175307 |
| LSx series engine high volume oil pump kit | L200315297 |
| LS7 & LSX block ladder frame main cap support kit, aka stud girdle | L200156006 |
| RHS block ladder frame main cap support kit, aka stud girdle | L200255305 |
| RHS block timing cover kit, wet sump (for raised camshaft sensor) | L200235305 |
| RHS dry sump timing cover kit, for LS7/LS9 oil pump drive | L200280206 |
| LS series engine turbocharger & supercharger oil feed block kit | L300015297 |
| LS series engine oil cooler adapter block kit | L300025297 |
| LS series engine turbocharger engine block coolant return fitting | L300035297 |
| Single Banjo Fitting, Stainless Steel, for turbocharger coolant lines, 3/8" | L960010000 |
| Double Banjo Fitting, Stainless Steel, for turbocharger coolant lines, 3/8" | L960020000 |
| LS1/LS6/LS2 Exhaust Flange, 304 Stainless, 3/8" Thick, Each | L400005897 |
| 6 bolt LS9 steel flywheel | L360010105 |
| 8 bolt LS9 steel flywheel | L360066509 |
| 9 bolt LS9 steel flywheel | L360040309 |
| LS7 intake valve seat, copper beryllium, 2.3200x1.9705x0.4500 | LNG-SI-LS7-A25 |
| LS7 exhaust valve seat, copper beryllium, 1.7205x1.3300x0.4500 | LNG-SE-LS7-A25 |
| F-body & GTO LS7 dry sump balancer kit, 10% underdrive | L220565298 |
| Camaro SS & CK truck LS7 dry sump balancer kit, 10% underdrive | L220575299 |
| LS engine damper friction washer, keyed | 12603843 |
| C5 oil pressure sensor relocation kit | L960215297 |
| Liquid to air intercooler manifold - LS1, LS6 and LS2 heads | L260035297 |
| Liquid to air intercooler manifold - LS3, LSA and LS9 heads | L260045307 |
| Liquid to air intercooler manifold, w. secondary inj provisions - LT1, L86 & L83 | L260056914 |
| C7 Corvette liquid to air intercooler manifold | L260060114 |
| LSx Lingenfelter logo valve cover kit, black | L810205299-B |
| LSx Lingenfelter logo valve cover kit, orange | L810205299-O |
| LSx Lingenfelter logo valve cover kit, polished | L810205299-P |
| Replacement LSx valve cover oil fill cap insert (GMPP 12341993/141-630) | XX05995-0001 |

Misc Engine Related Products & Tools



| Description | Part Number |
|---|------------------------|
| LSA & LS9 Pulley Removal & Install Tool Kit | L950066509 NEW! |
| Gen IV cylinder head dowel pin locator tool, LSA LS9 LS3 L92 | L950075307 |
| LSx series engine valve spring removal tool | L950025297 |
| Solid carbide 3/16" drill bit for drilling hardened materials including SC pulley shaft | L950010000 |
| Magnuson LS engine crank pinning kit | MAG31-14-59-009 |
| ATI Crankshaft / Harmonic Balancer Pinning Kit - LS1, LS6 & LS2 Engines | ATI918993 |
| Hydraulic roller retro fit cam button wear plate kit, L98/SBC | L200105000 |
| 02 Sensor Bung, M18-1.5, Stainless, Curved Face For 2.5-3.0" OD Exhaust | L400010000 |
| 02 Sensor Plug, M18-1.5, Stainless Steel | L400020000 |
| Single Banjo Fitting, Stainless Steel, for turbocharger coolant lines, 3/8" | L960010000 |
| Double Banjo Fitting, Stainless Steel, for turbocharger coolant lines, 3/8" | L960020000 |
| LT5 Engine Paint, 1990-1995 | L950010390 |
| M16x1.5x10.8mm alternator nut, fits most GM alternators | METRO85-82013 |
| LPE technician's screwdriver with #1 Phillips bit | L950050000 |
| Labor to have LPE machine a keyway in stock OEM dampers | CALL |

Camshafts And Other Valvetrain Related Products



| Description | Part Number |
|---|------------------------|
| 74211 camshaft, LT1/LT4/L98, hydraulic roller, 211/219 .333/.350, 112LS | L210015087 |
| 74216 camshaft, LT1/LT4/L98, hydraulic roller, 213/219 .309/.315, 112LS | L210025087 |
| 74219 camshaft, LT1/LT4/L98, hydraulic roller, 219/219 .350/.350, 112LS | L210035087 |
| 74220 camshaft, LT1/LT4/L98, hydraulic roller, 215/220 .333/.340, 114LS | L210045087 |
| GT1 LS series camshaft, 330/218 330/229 R113 | L210055297 |
| GT11 LS series camshaft, 371/215 379/231 R118 | L210065297 |
| GT1-1 LS series camshaft, 371/229 371/242 R1145 | L210075297 |
| GT2-3 LS series camshaft, 337/207 341/220 R1185 | L210085297 |
| GT9 LS series camshaft, 215/247 .629/.656 HR121 | L210150309 |
| GT17 LS series camshaft, LS7, 228/346 232/350 R112 | L210106006 |
| GT19 LS series camshaft, LS7, 227/376 239/383 R114 | L210116006 |
| GT21 LS series camshaft, LS7, 384/243 390/259 CL112 | L210146006 |
| GT2-3 LS series camshaft & spring kit, 337/207 341/220 R1185 | L210125297 |
| GT12 LS series camshaft, 227/235 .614/.621 HR115 | L210165897 |
| GT22 LS series camshaft, 228/346 232/350R118 | L210170106 |
| Gen V V8 AFM compatible camshaft, LT1/L86/L83, 222/234 .318/.294 R118 | L210186914 |
| GT30 Gen V V8 (LT1, L86, L83) camshaft, 217/229 w 576/576 LSA 116, AFM compatible | L210306914 NEW! |
| GT31 Gen V V8 (LT1, L86, L83) camshaft, 217/245 w 635/661 LSA 121 | L210316914 NEW! |
| GT32 Gen V V8 (LT1, L86, L83) camshaft, 225/241 w 643/657 LSA 114 | L210326914 NEW! |
| GT34 Gen V V8 (LT1, L86, L83) camshaft, 229/233 w 646/650 LSA 118 | L210346914 NEW! |
| LPE GM Gen V V8 camshaft phaser delete kit (LT1, L86, L83 engines) | L200326914 NEW! |
| RHS block timing cover kit, wet sump (for raised camshaft sensor) | L200235305 |
| RHS block dry sump timing cover kit, for LS7/LS9 oil pump drive | L200280206 |
| LS9 double valve spring retainers (set of 16) | XX04190-0016 |
| LPE beehive LS valve spring kit, 358 lbs @ 1.175", 0.625+ lift | L230055297 |
| LPE LS9 beehive valve spring kit (checked & sorted OEM LS9 valve springs) | L230045297 |
| LSx double valve spring kit with titanium retainers, seals, locks & spring seats | L230075897 |

Supercharger System Related Products



| Description | Part Number |
|--|-------------|
| LSA to LS9 supercharger conversion front cover | L250406509 |
| LPE LS9 supercharger front cover (LPE pulleys and air intake required) | L250110309 |
| LS9 HD bar & plate replacement intercooler core assembly, each | L320076109 |
| HD carbon fiber jackshaft for Magnuson SC kits, 22.060" center to center | L250472206 |
| HD carbon fiber jackshaft for Magnuson SC kits, 18.168" center to center, 2010-2013 Camaro SS <i>(other custom order lengths also available)</i> | L250481817 |
| 2.75" 10 rib supercharger pulley, 4 bolt for Magnuson SC systems | L220080000 |
| 2.95" 10 rib supercharger pulley, 4 bolt for Magnuson SC systems | L220090000 |
| 3.00" 14 rib rear supercharger pulley, 4 bolt for Magnuson SC systems | L220180000 |
| 3.25" 14 rib rear supercharger pulley, 4 bolt for Magnuson SC systems | L220190000 |
| 3.49" 14 rib rear supercharger pulley, 4 bolt for Magnuson SC systems | L220200000 |
| 30 tooth cogged pulley, 50 mm, 4 bolt for Magnuson SC systems | L220320030 |
| 35 tooth cogged pulley, 50 mm, 4 bolt for Magnuson SC systems | L220330035 |
| 70 mm OD guided 50 mm cogged belt idler, smooth backside | L220350070 |
| 70 mm x 56 mm wide double bearing idler pulley, 12 & 14 rib | L250270070 |
| 76 mm double bearing idler pulley kit, 8 to 11 rib | L250120309 |
| 90 mm double bearing idler pulley kit, 8 to 11 rib | L250260090 |
| 100 mm double bearing idler pulley kit, 8 to 11 rib | L250130309 |
| Magnuson Supercharger Rear Tensioner Bracket Assembly, polished | L220280000 |
| Magnuson Supercharger Rear Tensioner Bracket Assembly, black | L220160000 |
| 2010-2014 10 rib Camaro kit with 7.3" OD balancer | L220251410 |
| 2010-2014 10 rib Camaro kit with 7.8" OD balancer | L220261410 |
| 2010-2014 10 rib Camaro kit with 8.0" OD balancer | L220271410 |
| 10 rib C6 LS2 and LS3 (wet sump only) Corvette kit with 7.3" OD balancer | L220230197 |
| 10 rib C6 LS2 and LS3 (wet sump only) Corvette kit with 8.0" OD balancer | L220240197 |
| 10 rib C6 Z06 LS7 Corvette kit with 8.0" OD balancer (overdrive) | L220220206 |
| CK truck 10 rib accessory drive kit, 7.3" damper | L220510607 |
| CK truck 10 rib accessory drive kit, 7.8" damper | L220520607 |
| CK truck 10 rib accessory drive kit, 8.0" damper | L220530607 |
| C5 Corvette Edelbrock E-Force supercharger install kit | L250280197 |
| 25.4" 14 rib rear supercharger jackshaft drive belt, 644 mm | 14PK644 |

Supercharger System Related Products (continued)

| Description | Part Number |
|--|--------------------|
| 600 mm x 50 mm cogged belt | GAT600-8MGT-50 |
| 2745 mm 10 rib belt, Corvette, CK truck and Trailblazer SS 10 rib kits | 10PK2745 |
| 2470 mm 10 rib belt, Camaro SS 10 rib kits | 10PK2470 |
| 1655mm / 65.2" 8 rib belt | 8PK1655 |
| 1643mm / 64.5" 8 rib belt | K080645 |
| 1702mm / 67.0" 8 rib belt | K080670 |
| 1715mm / 67.5" 8 rib belt | K080675 |
| 1727mm / 68.0" 8 rib belt | K080680 |
| 1742mm / 68.5" 8 rib belt | K080685 |
| 1775mm / 70.0" 8 rib belt | K080700 |
| 2096mm / 82.5" 11 rib belt | K110825 |
| 2185mm / 86.0" 11 rib belt | 11PK2185 |

Air Intake Kits & Related Components



| Description | Part Number |
|--|--------------------|
| GREEN AIR FILTER C7 CORVETTE STINGRAY LT1, 2014-15 | GF7225 |
| C6 Z06 LS7 air intake kit, 2006-2013 | L650090206 |
| C6 LS2 air intake kit, 2005-2007 | L650070105 |
| Pontiac GTO air intake kit, 2005-2006 | L650060505 |
| Cadillac CTS-V air intake kit, 2004-2007 (LS6 and LS2 engines) | L650050704 |
| C6 ZR1 air intake kit (for LPE SC front cover), 2009-2013 | L650150309 |
| Cadillac CTS-V LSA air intake duct kit, 2009-2014 | L650150309 |
| ZL1 air intake duct kit (for stock air box), 2012-2014 | L650172012 |
| Low restriction ZL1 air intake kit, no ECU calibration needed, 2012-2014 | L650182012 |
| LPE 2004 GTO air intake replacement filter (for LPE air intake kit) | L660030504 |
| LPE 2004-2007 CTS-V air intake replacement filter (for LPE air intake kit) | L660050704 |
| LPE 2005-2006 GTO air intake replacement filter (for LPE air intake kit) | L660060505 |
| LPE 2005-2013 C6 Corvette air intake replacement filter (for LPE air intake kit) | L660070105 |
| Cone air filter, 9" tall, 6" base, 4" ID (fits LPE F-body LT1 air intakes) | L660010493 |

Fuel System Related Products



| Description | Part Number |
|---|------------------------|
| 350 LPH 46 mm E85 fuel pump kit | L760070000 |
| 46 mm E85 fuel pump outlet fitting, -6 AN JIC, with check valve | L750050000 |
| 46 mm E85 pump outlet fitting, hose barb, without check valve | XX03547-0011 |
| 46 mm E85 pump outlet fitting, -6 AN JIC, without check valve | XX03547-0013 |
| ZR1 Corvette replacement fuel pump kit, 1990-1995, standard volume | L710030390 |
| ZR1 Corvette replacement fuel pump kit, 1990-1995, high volume | L710040390 |
| 2007 Suburban & Yukon XL fuel pump kit (for GM 19133475 module) | L710050607 |
| 2010-2014 Camaro Fuel Pump Voltage Booster Kit | L460111410 |
| 2010-2014 Camaro SS twin pump system, electronic control | L710071410 |
| 2010-2014 Camaro SS twin pump system, mechanical regulator | L710081410 |
| C5 Corvette High Flow Fuel Pump Module, 1997-2003 C5 Corvette | L710650197 |
| High Flow GTO Fuel Pump Kit, 2004-2006 Pontiac GTO | L710660504 |
| Trailblazer and SSR High Flow Fuel Pump Kit, 2005-2009 | L710111005 |
| C6 Corvette Passenger Side Fuel Pressure Regulator Bypass Plug, RED | L750000103 |
| C6 Corvette driver side fuel pump module regulator plug with jet supply orifice | L760080103 NEW! |
| C6 Corvette Driver Side Fuel Pressure Regulator Bypass Plug, BLUE | L750010103 |
| Adjustable EFI Fuel Pressure Regulator Kit | L740010000 |
| USCar injector connector kit | L480080000 |
| Sumitomo/Minitimer injector connect kit | L480090000 |
| LS2/LS7/LS3 fuel injector conversion O-ring, kit, set of 8 | L700025305 |
| High flow LS9 LSA injector, 62 lbs/hr, 668 cc/min, angled spray | L730100309 |
| Bosch Motorsports 980 cc/min injectors, short, USCar connector | BOS0280158040 |
| 2009-2015 Cadillac CTS-V fuel pump module regulator block off relief valve | XX03547-0010 |
| ZL1 fuel pump connector kit | L480241412 |
| TI Auto 416 LPH 39/50 DCSS E85 compatible fuel pump | TI-F90000267 |
| 416 LPH 39/50 DCSS F90000267 wiring harness | TI-000107694/AA |
| High flow E85 compatible C6 fuel pump module, internal regulator, '05-'06 MY | L710120105 NEW! |
| High flow E85 compatible C6 fuel pump module, internal regulator, '07-'13 MY | L710130106 NEW! |
| Fuel line t-fitting with check valve assembly (3/8" I/O) | L760100000 NEW! |

Electronic Products



| Description | Part Number |
|--|------------------------|
| VSFM-001 variable speed fan & pump temperature controller | L460320000 NEW! |
| TRG-002 58x to 24x conversion module | L460065397 |
| RPM-003 RPM activated switch with window switch mode & TPS/Clutch Input | L460160000 |
| STOV-003 MPH activated switch/MPH to voltage converter | L460270000 |
| LNC-003 2-step launch controller kit | L460105297 |
| LNC-2000 RPM limiter/launch controller with timing retard function | L460145297 |
| LNC-2001 2-step and timing retard controller (for LSA & LS9 applications) | L460216509 |
| LNC-TC1 engine torque cut module with RPM limiter/launch controller function | L460135297 |
| LNC-TRM LSx timing control & torque reduction module | L460285297 |
| LNC-2014 RPM limiter/launch controller w timing retard function for Gen V V8 | L460306914 |
| CAN2-002 CAN to analog & PWM gauge and relay output module | L460260704 |
| TBRC-001 Temperature-Based Relay Controller | L460220000 |
| CTAP-001 Clutch and Throttle Activation Position switch | L460190108 |
| CTAP-001 to Camaro, Corvette & CTS-V clutch position sensor PNP harness | L480370108 |
| LS3, LS2, LS7, LSA, LS9 throttle body ext harness w TPS signal wire output | CE105454 |
| NCC-002 two stage progressive nitrous controller | L460240000 |
| NCC-002 nitrous controller kit with harnesses & sensors (for EFI applications) | L460200000 |
| 0-15 PSI pressure sensor (fuel, boost) | L480250015 |
| 0-150 PSI pressure sensor (fuel, boost) | L480260150 |
| 0-2000 PSI pressure sensor (fuel, nitrous, brake) | L480272000 |
| Fuel pressure sensor harness | L480290000 |
| Nitrous pressure sensor harness | L480300000 |
| NCC-001 & NCC-002 primary wiring harness | L480310000 |
| Load cell shift knob | L350170000 |
| LPE 100mm / 4" mass air flow (MAF) sensor assembly, with sensor | L480000000 |
| EFILive AutoCAL | EFIAutoCAL |
| Transient Voltage Suppression (TVS) diode | L450080000 |
| 40 amp sealed relay kit | L450100000 |
| 20AMP solid state relay, SPST | HELLAH41773001 |
| OBD II diagnostic link connector (DLC) port cover kit | L450110095 |
| SPDT microswitch kit | L480330000 |

5-Axis CNC Head Porting Services



| Description | Part Number |
|---|-------------|
| L98 cyl head, full CNC port & PTST | L160015088 |
| LT1 cyl head, full CNC port & PTST | L160045492 |
| LT4 cyl head, full CNC port & PTST | L160075596 |
| LS1 cyl head, full CNC port & PTST | L160105897 |
| LS1, CNC & PTST chamber only | L160115897 |
| LS1 cyl head, intake & exh runners only, CNC port & PTST | L160125897 |
| LS6 & LS2 cyl head, full CNC port & PTST | L160135901 |
| LS6 & LS2 cyl head, CNC & PTST chamber only | L160145901 |
| LS6 & LS2 cyl head, intake & exh runners only, CNC port & PTST | L160155901 |
| LS2 & LS6 cyl head, convert to LQ4 chamber, full CNC port & PTST | L160165901 |
| LS2 & LS6 cyl head, convert to LQ4 chamber, CNC & PTST chamber only | L160175901 |
| LQ4 & LQ9 6.0L cyl head, full CNC port & PTST | L160185201 |
| LQ4 & LQ9 6.0L cyl head, CNC & PTST chamber only | L160195201 |
| LQ4 & LQ9 6.0L cyl head, intake & exh runners only, CNC port & PTST | L160205201 |
| 5.3 cyl head, convert to LS1, full CNC port & PTST | L160215299 |
| LS7 cyl head, intake & exh runners only, CNC port & PTST | L160226006 |
| LS3, L92 & L76 cyl head, full CNC port & PTST | L160235307 |
| LS3, L92 & L76 cyl head, CNC & PTST chamber only | L160245307 |
| LS3, L92 & L76 cyl head, intake & exh runners only, CNC port & PTST | L160255307 |
| LS3, L92 & L76 cyl head, CNC port and PTST exhaust only | L160265307 |
| C5R cyl head, full CNC port & PTST | L160275200 |
| 8.1L iron cyl head, full CNC port & PTST | L160286501 |
| Edelbrock LS1 cyl head, small port, full CNC port & PTST | L160295200 |
| Edelbrock LS1 cyl head, big port, full CNC port & PTST | L160305200 |
| Edelbrock LT1 cyl head, full CNC port & PTST | L160315100 |
| Viper cyl head, full CNC port & PTST | L160320992 |
| LSA & LS9 cyl head, full CNC port & PTST | L160335309 |
| LSA & LS9 cyl head, CNC & PTST chamber only | L160345309 |
| LSA & LS9 cyl head, intake & exh runners only, CNC port & PTST | L160355309 |
| LSA & LS9 cyl head, CNC port and PTST exhaust only | L160365309 |
| LT1/L86 Gen V DI V8 cylinder head, CNC port | NEW! |

Miscellaneous Products



| Description | Part Number |
|--|-----------------|
| Oil-air separator | L200010000 |
| Oil-air separator replacement filter | L200020000 |
| Oil-air separator check valve | L200030000 |
| C5 Oil-air separator mounting bracket | L200160197 |
| C6 Oil-air separator mounting bracket | L200170105 |
| Stewart EMP high output intercooler fluid pump, 9A | ST-E2512A |
| Stewart EMP high output intercooler fluid pump, high flow program, 25A | ST-1030002107 |
| VariMax intercooler pump w bracket and connector kit | TAFX410110 |
| Bosch to VariMax intercooler pump adapter harness | L480340000 |
| Bosch intercooler pump, 1150 lph, PCA | BOS0392-022-002 |
| Bosch intercooler fluid pump, bracket and harness kit | L330010000 |
| Bosch intercooler pump harness | L480010000 |
| Boost-A-Pump pressure switch mounting bracket | L960200000 |
| Starter heat shield | L800010000 |
| 02 Sensor Bung, M18-1.5, Stainless, Curved Face For 2.5-3.0" OD Exhaust | L400010000 |
| 02 Sensor Plug, M18-1.5, Stainless Steel | L400020000 |
| Single Banjo Fitting, Stainless Steel, for turbocharger coolant lines, 3/8" | L960010000 |
| Double Banjo Fitting, Stainless Steel, for turbocharger coolant lines, 3/8" | L960020000 |
| Momo anatomic shift knob, black with Alcantara, black stitching w/ LPE logo | L350140000 |
| Momo anatomic shift knob, black with Alcantara, silver stitching w/ LPE logo | L350150000 |
| Momo anatomic shift knob, black with Alcantara, red stitching w/ LPE logo | L350160000 |
| 5th Gen Camaro shift boot collar kit | L350191410 |
| Lingenfelter license plate frame, brass frame, BLACK | L900040000 |
| Lingenfelter license plate frame, brass frame, chrome w black letters | L900050000 |
| LPE bumper sticker & sponsor decal, 10-3/4" x 3-1/4" | L920180000 |
| LPE banner, 28" x 72", w grommets & clear coat for outside use, single sided | L920130000 |
| Universal differential/transmission vent bladder kit | L380180000 |

Thermostats



| Description | Part Number |
|---|------------------------|
| Thermostat, 160 degree, LT1/LT4, 1992-1997 | L310025192 |
| Thermostat, 160 degree, LS1/LS6, 1997-2004 | L310045297 |
| Thermostat, 160 degree, LS1/LS6, 1997-2004, NO HOUSING | L310145297 |
| Thermostat, 180 degree, LS1/LS6, 1997-2004 | L310035297 |
| Thermostat, 160 degree, LS2/LS7, 2004-2008 | L310015204 |
| Thermostat, 180 degree, LS2/LS7, 2004-2008 | L310055204 |
| Thermostat, 160 degree, CK truck/Trailblazer '07-13, LS3/L99/LSA/LS9 '09-13 | L310065307 |
| Thermostat, 174 degree, CK truck/Trailblazer '07-13, LS3/L99/LSA/LS9 '09-13 | L310155307 |
| Thermostat, 160 degree, Ecotec | L310126305 |
| Thermostat, 180 degree, Ecotec (stock replacement) | L310086305 |
| Thermostat, 176 degree, Northstar thermostat, 2005-2007 | L310106405 |
| Thermostat kit, 180 degree, Mustang, V8, 2005-2007, w gasket | L310071201 |
| Thermostat, 160 degree, Dodge V10/Viper, 1992-2008 & Ford GT | L310110992 |
| Thermostat, 170 degree, Dodge V10/Viper, 1992-2008 & Ford GT | L310130992 |
| Thermostat, 180 degree, Hemi, 2005-2008 | L310096205 |
| 160 degree thermostat, GM Gen V V8 & V6 engines (LT1, L86, L83, LV1, LV3) | L310166914 NEW! |
| 170 degree thermostat, GM Gen V V8 & V6 engines (LT1, L86, L83, LV1, LV3) | L310176914 NEW! |
| 180 degree thermostat, GM Gen V V8 & V6 engines (LT1, L86, L83, LV1, LV3) | L310186914 NEW! |

| GM Thermostats - Cadillac, Chevrolet, Pontiac & Saturn cars | | | | | | |
|--|-------------|---------------------|--------------------|---------------|---------------|---------------|
| Year | Make | Model | Engine | 160° F | 176° F | 180° F |
| 2004-2005 | Cadillac | CTS-V | LS6 5.7L | L310015204 | N/A | L310055204 |
| 2006-2007 | Cadillac | CTS-V | LS2 6.0L | L310015204 | N/A | L310055204 |
| 2009-2013 | Cadillac | CTS-V | LSA 6.2L SC | L310065307 | N/A | N/A |
| 2006-2008 | Cadillac | Various | Northstar | N/A | L310106405 | N/A |
| 2006-2008 | Cadillac | STS-V | 4.4L SC | N/A | L310106405 | N/A |
| 2006-2009 | Cadillac | XLR-V | 4.4L SC | N/A | L310106405 | N/A |
| 1984-1992 | Chevrolet | Camaro | L98 5.7L | L310005000 | N/A | N/A |
| 1993-1997 | Chevrolet | Camaro | LT1 5.7L | L310025192 | N/A | N/A |
| 1998-2002 | Chevrolet | Camaro | LS1 5.7L | L310045297 | N/A | L310035297 |
| 2010-2013 | Chevrolet | Camaro SS | LS3 6.2L | L310065307 | N/A | N/A |
| 2005-2008 | Chevrolet | Cobalt | 2.2L and 2.4L | L310026305 | N/A | L310086305 |
| 1985-1991 | Chevrolet | C4 Corvette | L98 5.7L | L310005000 | N/A | N/A |
| 1992-1996 | Chevrolet | C4 Corvette | LT1 and LT4 | L310025192 | N/A | N/A |
| 1997-2003 | Chevrolet | C5 Corvette | LS1 and LS6 | L310045297 | N/A | L310035297 |
| 2004 | Chevrolet | C5 Corvette | LS1 and LS6 | L310015204 | N/A | L310055204 |
| 2005-2007 | Chevrolet | C6 Corvette | LS2 6.0L | L310015204 | N/A | L310055204 |
| 2008 | Chevrolet | C6 Corvette | LS3 6.2L | L310015204 | N/A | L310055204 |
| 2009-2013 | Chevrolet | C6 Corvette | LS3 6.2L | L310065307 | N/A | N/A |
| 2006-2008 | Chevrolet | C6 Corvette Z06 | LS7 7.0L | L310015204 | N/A | L310055204 |
| 2009-2013 | Chevrolet | C6 Corvette Z06 | LS7 7.0L | L310065307 | N/A | N/A |
| 2009-2013 | Chevrolet | C6 Corvette ZR1 | LS9 6.2L SC | L310065307 | N/A | N/A |
| 2006-2008 | Chevrolet | HHR | 2.0L T, 2.2L, 2.4L | L310126305 | N/A | L310086305 |
| 1994-1996 | Chevrolet | Impala SS | LT1 5.7L | L310025192 | N/A | N/A |
| 2006-2007 | Chevrolet | Impala SS | 5.3L | L310015204 | N/A | L310055204 |
| 2006-2007 | Chevrolet | Monte Carlo SS | 5.3L | L310015204 | N/A | L310055204 |
| 1984-1992 | Pontiac | Firebird | L98 5.7L | L310005000 | N/A | N/A |
| 1993-1997 | Pontiac | Firebird | LT1 5.7L | L310025192 | N/A | N/A |
| 1998-2002 | Pontiac | Firebird | LS1 5.7L | L310045297 | N/A | L310035297 |
| 2004 | Pontiac | GTO (early style) | LS1 5.7L | L310045297 | N/A | L310035297 |
| 2004 | Pontiac | GTO (late style) | LS1 5.7L | L310015204 | N/A | L310055204 |
| 2005-2006 | Pontiac | GTO | LS2 6.0L | L310015204 | N/A | L310055204 |
| 2008 | Pontiac | G8 GT (early style) | LY7 6.0L | L310015204 | N/A | L310055204 |
| 2008-2009 | Pontiac | G8 GT (late style) | LY7 6.0L | L310065307 | N/A | N/A |
| 2009 | Pontiac | G8 GXP | LS3 6.2L | L310065307 | N/A | N/A |
| 2006-2007 | Pontiac | Grand Prix GXP | 5.3L | L310015204 | N/A | L310055204 |
| 2006-2008 | Pontiac | Solstice | 2.0L T, 2.4L | L310126305 | N/A | L310086305 |
| 2007-2008 | Pontiac | G5 | 2.2, 2.4 L | L310126305 | N/A | L310086305 |
| 2007-2008 | Saturn | Sky | 2.0L T, 2.4L | L310126305 | N/A | L310086305 |

| GM & AC Delco OEM stock temperature thermostat part number cross reference to LPE low temperature thermostats: | | | | |
|---|------------------------|----------------------|----------------------|----------------------|
| GM Part # | AC Delco Part # | LPE 160 deg F | LPE 176 deg F | LPE 180 deg F |
| 12571261 | 15-10412 | L310045297 | N/A | L310035297 |
| 12600171 | 131-156 | L310015204 | N/A | L310055204 |
| 89018168 | 131-160 | L310065307 | N/A | N/A |

GM Thermostats - Cadillac, Chevrolet & GMC trucks

| Year | Make | Model | Engine | 160° F | 176° F | 180° F |
|-------------|-------------|------------------|------------------|---------------|---------------|---------------|
| 2002-2003 | Cadillac | Escalade | 6.0L | L310045297 | N/A | L310035297 |
| 2004-2006 | Cadillac | Escalade | 6.0L | L310015204 | N/A | L310055204 |
| 2007-2013 | Cadillac | Escalade | 6.2L | L310065307 | N/A | N/A |
| 2004-2006 | Chevy/GMC | Envoy | 5.3L | L310015204 | N/A | L310055204 |
| 2007-2009 | Chevy/GMC | Envoy | 5.3L | L310065307 | N/A | N/A |
| 2004-2006 | Chevy/GMC | Trailblazer | 5.3L | L310015204 | N/A | L310055204 |
| 2006 | Chevy/GMC | Trailblazer SS | 6.0L | L310015204 | N/A | L310055204 |
| 2007-2009 | Chevy/GMC | Trailblazer | 5.3L | L310065307 | N/A | N/A |
| 2007-2009 | Chevy/GMC | Trailblazer SS | 6.0L | L310065307 | N/A | N/A |
| 2003-2004 | Chevy | SSR | 5.3L | L310045297 | N/A | L310035297 |
| 2005-2006 | Chevy | SSR | 6.0L | L310015204 | N/A | L310055204 |
| 2000-2003 | Chevy | Tahoe & Suburban | 4.8L, 5.3L, 6.0L | L310045297 | N/A | L310035297 |
| 2004-2006 | Chevy | Tahoe & Suburban | 4.8L, 5.3L, 6.0L | L310015204 | N/A | L310055204 |
| 2007-2008 | Chevy | Tahoe & Suburban | 4.8L, 5.3L, 6.0L | L310065307 | N/A | N/A |
| 2000-2003 | GMC | Yukon & Yukon XL | 4.8L, 5.3L, 6.0L | L310045297 | N/A | L310035297 |
| 2004-2006 | GMC | Yukon & Yukon XL | 4.8L, 5.3L, 6.0L | L310015204 | N/A | L310055204 |
| 2007-2008 | GMC | Yukon & Yukon XL | 4.8L, 5.3L, 6.0L | L310065307 | N/A | N/A |
| 1999-2003 | Chevy/GMC | Silverado/Sierra | 4.8L, 5.3L, 6.0L | L310045297 | N/A | L310035297 |
| 2004-2006 | Chevy/GMC | Silverado/Sierra | 4.8L, 5.3L, 6.0L | L310015204 | N/A | L310055204 |
| 2007-2013 | Chevy/GMC | Silverado/Sierra | 4.8L, 5.3L, 6.0L | L310065307 | N/A | N/A |
| 2003 | Hummer | H2 | 6.0L | L310045297 | N/A | L310035297 |
| 2004-2006 | Hummer | H2 | 6.0L | L310015204 | N/A | L310055204 |
| 2007 | Hummer | H2 | 6.0L | L310065307 | N/A | N/A |
| 2008-2009 | Hummer | H2 | 6.2L | L310065307 | N/A | N/A |
| 2008-2010 | Hummer | H3 Alpha | 5.3L | L310065307 | N/A | N/A |

Chrysler, Dodge, Ford and Jeep Thermostats (Car, Truck & SUV)

| Year | Make | Model | Engine | 160° F | 176° F | 180° F |
|-------------|-------------|----------------------|-----------------|---------------|---------------|---------------|
| 2005-2008 | Chrysler | 300C | 5.7L | N/A | N/A | L310096205 |
| 2005-2008 | Chrysler | 300C SRT-8 | 6.1L | N/A | N/A | L310096205 |
| 2006-2008 | Dodge | Charger R/T | 5.7L | N/A | N/A | L310096205 |
| 2006-2008 | Dodge | Charger SRT-8 | 6.1L | N/A | N/A | L310096205 |
| 2005-2008 | Dodge | Magnum | 5.7L Hemi | N/A | N/A | L310096205 |
| 2005-2008 | Dodge | Magnum SRT-8 | 6.1L Hemi | N/A | N/A | L310096205 |
| 1992-2008 | Dodge | Viper | 8.0L, 8.3L | L310110992 | L310130992 | N/A |
| 2005-2008 | Dodge | Durango | 5.7L Hemi | N/A | N/A | L310096205 |
| 2005-2008 | Dodge | Ram 1500 | 5.7L, 6.1L Hemi | N/A | N/A | L310096205 |
| 2005-2008 | Dodge | Ram 2500 | 5.7L, 6.1L Hemi | N/A | N/A | L310096205 |
| 2005-2008 | Dodge | Ram 3500 | 5.7L, 6.1L Hemi | N/A | N/A | L310096205 |
| 2004-2006 | Dodge | Ram SRT-10 | 8.3L Hemi | L310110992 | L310130992 | N/A |
| 2005-2006 | Ford | GT | 5.4L | L310110992 | L310130992 | N/A |
| 2005-2007 | Ford | Mustang | 4.6L | L310071201 | N/A | N/A |
| 2006-2008 | Jeep | Commander | 5.7L | N/A | N/A | L310096205 |
| 2007-2008 | Jeep | Grand Cherokee SRT-8 | 6.1L | N/A | N/A | L310096205 |
| 2006-2008 | Jeep | Grand Cherokee | 5.7L | N/A | N/A | L310096205 |

Cooling System Related Products



| Description | Part Number |
|--|------------------------------------|
| C6 ZR1 style radiator for Z06 Corvette - (provides intercooler clearance for supercharged & turbo applications) | XX05930-0001 <i>NEW!</i> |
| LS9 HD bar & plate replacement intercooler core assembly, each | L320076109 |
| Lingenfelter liquid to air intercooler manifold - LS1, LS6 and LS2 heads | L260035297 |
| Lingenfelter liquid to air intercooler manifold - LS3, LSA and LS9 heads | L260045307 |
| Liquid to air intercooler manifold, w. secondary inj provisions - LT1, L86 & L83 | L260056914 |
| C7 Corvette intercooler manifold | L260060114 <i>NEW!</i> |
| Camaro SS/ZL1 intercooler radiator and fan kit | L320042012 |
| ZL1 intercooler reservoir kit (LPE air intake required) | L300152012 |
| CTS-V intercooler radiator and fan kit (includes PS cooler kit) | L320030709 |
| CTS-V power steering cooler kit, 2009-2014 | L320050709 |
| CTS-V intercooler pump upgrade kit (VariMax pump + CTS-V harness) | L330030709 |
| 2007-2013 Suburban auxiliary fan kit, standard fans w/ AC based control (no ECM programming, stock alternator) | L300080607 |
| 2007-2013 Suburban auxiliary fan kit, ECM control (requires ECM programming, does not work with OEM electric fan equipped vehicles) | L300090607 |
| 2007-2013 Suburban high output fan kit, ECM control (requires ECM programming and high output alternator, does not work with vehicles equipped with OEM electric fans) | L300130607 |
| CAN2-002 CAN to analog & PWM gauge and relay output module | L460260704 |
| TBRC-001 Temperature-Based Relay Controller | L460220000 |
| VFSM-001 variable speed fan & pump temperature controller | L460320000 |
| Spal 225 mm fan, AP7 high output motor with WeatherPak connector | SPAL-30100585li |
| Spal 255 mm fan with WeatherPak connector | SPAL-30100374li |
| Spal 255 mm fan, AP7 high output motor with WeatherPak connector | SPAL-30100320li |
| Stewart EMP high output intercooler fluid pump, 9A | ST-E2512A |
| Stewart EMP high output intercooler fluid pump, high flow program, 25A | ST-1030002107 |
| VariMax intercooler pump w bracket and connector kit | TAFX410110 |
| Bosch to VariMax intercooler pump adapter harness | L480340000 |
| Bosch intercooler pump, 1150 lph, PCA | BOS0392-022-002 |
| Bosch intercooler fluid pump, bracket and harness kit | L330010000 |
| Bosch intercooler pump harness | L480010000 |

Cooling System Related Products (continued)



| Description | Part Number |
|---|-------------------|
| Setrab M22 to -10 AN FITTING | SET22-M22AN10SE |
| Setrab M22 to -12 AN FITTING | SET22-M22AN12SE |
| Setrab M22 to 3/4 pushlock barb fitting, straight | SET22-M22PL1200 |
| Setrab M22 to 3/4 pushlock barb fitting, 45 degree | SET22-M22PL1245 |
| Setrab M22 to 3/4 pushlock barb fitting, 90 degree | SET22-M22PL1290 |
| Setrab M22 to 3/8 pushlock barb fitting, straight | SET22M22PL06-00 |
| Setrab M22 to 3/8 pushlock barb fitting, 90 degree | SET22M22PL06-90 |
| Setrab sensor or gauge adapter fitting, -6AN male/female, 1/8 port | SET22AN06AN06NP18 |
| Setrab 172 heat exchanger, 72 row, 6.4x22.1x1.83 | SET50-172-7612 |
| Setrab 634 heat exchanger, 34 row, 11.1x10.4x1.83 | SET50-634-7612 |
| Setrab 640 heat exchanger, 40 row, 11.1x12.2x1.83 | SET50-640-7612 |
| Setrab 650 heat exchanger, 50 row, 11.1x15.3x1.83 | SET50-650-7612 |
| Setrab 660 heat exchanger, 60 row, 11.1x18.3x1.83 | SET50-660-7612 |
| Setrab 910 heat exchanger, 10 row, 14.1x3.0x1.83 | SET50-910-7612 |
| Setrab 34 row 6 series 11.375x10.25 heat exchanger with fan | SETFP634M22i |
| LS series engine oil cooler adapter block, for -10 AN lines | L300025297 |
| LS series engine turbocharger/supercharger oil feed block or aux oil temperature sensor gauge block | L300015297 |
| Oil scavenge & circulation pump, 2gpm, 12 vdc | TWX-200M-12V |
| Oil scavenge & circulation pump, 3gpm, 12 vdc | TWX-300-12V |

| 2009-2013 Chevrolet ZR1 Corvette and GMPP LS9 Crate Engine Pulley Chart | | | | | | | | | | | | |
|---|----------------------|--------------------------|----------------------------|---------------------------|----------|----------------------|-----------------|-------------------|-----------------|--------------|-----------|---------------------|
| Damper Size | Damper Part # | Supercharger Pulley Size | Supercharger Pulley Part # | Belt Size | Belt PN | Passenger Side Idler | PS Idler kit PN | Driver Side Idler | DS Idler kit PN | Pulley ratio | Total OD% | SC speed @ 6500 RPM |
| 7.33" stock | OEM GM or L220550309 | stock 3.1" | NA | stock 2137 mm | 12627521 | stock 76 mm | NA | stock 90 mm | NA | 2.4 | NA | 15376 |
| 7.33" stock | OEM GM or L220550309 | 2.6" | L220040309 or L220146109 | stock 2137 mm | 12627521 | stock 76 mm | NA | 100 mm | L250130309 | 2.8 | 19% | 18333 |
| 7.33" stock | OEM GM or L220550309 | 2.35" | L220136109 | 82.5 inch 11 rib belt | K110825 | stock 76 mm | NA | 76 mm | L250120309 | 3.1 | 32% | 20321 |
| 8.34" 14% OD | L220100309 | stock 3.1" | NA | 2185 mm 11 rib belt | 11PK2185 | stock 76 mm | NA | stock 90 mm | NA | 2.7 | 14% | 17495 |
| 8.34" 14% OD | L220100309 | 2.6" | L220040309 or L220146109 | 2160 mm 11 rib belt | 11PK2160 | stock 76 mm | NA | stock 90 mm | NA | 3.2 | 36% | 20859 |
| 8.34" 14% OD | L220100309 | 2.35" | L220136109 | stock 2137 mm 11 rib belt | 12627521 | stock 76 mm | NA | 76 mm | L250120309 | 3.6 | 50% | 23078 |

Warning: For performance and durability reasons LPE does not recommend exceeding 23,000 RPM supercharger speed.

NOTE: Two piece SC pulleys require LPE LS9 supercharger front cover or 10 bolt hub kit. Stock GM SC front cover requires machining to use the 2.35" pulley

Table 1 - belt length and idler pulley diameters required for different LSA supercharger pulley and damper pulley combinations.

| Crank Pulley PN (Crank only OD%) | Supercharger Pulley | Supercharger Pulley PN | Belt | Belt PN | Upper Idler | Lower Idler | Idler Bracket (PN) | Pulley Ratio | Total OD% | SC Speed @ 6500 RPM |
|---|---------------------|------------------------|--------------|----------|---|--|---------------------|--------------|-----------|---------------------|
| stock 7.8" (L220646509) (0%) | stock 3.0" | - | stock 1680mm | 12628026 | stock 90 mm | stock 70 mm | stock | 2.6 | N/A | 16,900 |
| | 2.55" press-on | L220030709 | 1655mm/65.2" | 8PK1655 | stock 90 mm | stock 70 mm | | 3.1 | 18% | 19,900 |
| | 2.55" 10 bolt | L220300709 | 1655mm/65.2" | 8PK1655 | stock 90 mm | stock 70 mm | | 3.1 | 18% | 19,900 |
| | 2.38" 10 bolt | L220310709 | 1643mm/64.5" | K080645 | stock 90 mm | stock 70 mm | | 3.3 | 26% | 21,300 |
| 8.25" L220060709 (6%) | stock 3.0" | - | stock 1680mm | 12628026 | stock 90 mm | stock 70 mm | stock | 2.8 | 6% | 17,900 |
| | 2.55" press-on | L220030709 | 66.0" | K080660 | stock 90 mm | stock 70 mm | | 3.2 | 25% | 21,000 |
| | 2.55" 10 bolt | L220300709 | 66.0" | K080660 | stock 90 mm | stock 70 mm | | 3.2 | 25% | 21,000 |
| | 2.38" 10 bolt | L220310709 | stock 1680mm | 12628026 | LPE 100 mm, 0.350" spacer, M10x1.5x60mm cap head screw | stock 70 mm | | 3.5 | 34% | 22,500 |
| 8.66" L220070709 (11%) | stock 3.0" | - | 67.5" | K080675 | stock 90 mm | stock 70 mm | stock | 2.9 | 11% | 18,800 |
| | 2.55" press-on | L220030709 | 67.0" | K080670 | stock 90 mm | stock 70 mm | | 3.4 | 31% | 22,100 |
| | 2.55" 10 bolt | L220300709 | 67.0" | K080670 | stock 90 mm | stock 70 mm | | 3.4 | 31% | 22,100 |
| | 2.38" 10 bolt | L220310709 | - | - | stock 90 mm | stock 70 mm | | 3.6 | 40% | 23,700 |
| 9.17" L220170709 (18%) | stock 3.0" | - | 67.5" | K080675 | stock 90 mm | stock 70 mm | LPE (L220636509) | 3.1 | 18% | 19,900 |
| | 2.55" press-on | L220030709 | 67.0" | K080670 | stock 90 mm | stock 70 mm | | 3.6 | 38% | 23,400 |
| | 2.55" 10 bolt | L220300709 | 67.0" | K080670 | stock 90 mm | stock 70 mm | | 3.6 | 38% | 23,400 |
| | 2.38" 10 bolt | L220310709 | - | - | stock 90 mm | stock 70 mm | | 3.9 | 48% | 25,000 |
| 9.55" L220290709 (23%) | stock 3.0" | - | 68.5" | K080685 | stock 90 mm | stock 70 mm | LPE (L220636509) | 3.2 | 23% | 20,700 |
| | 2.55" press-on | L220030709 | 67.5" | K080675 | stock 90 mm | stock 70 mm | | 3.8 | 44% | 24,300 |
| | 2.55" 10 bolt | L220300709 | 67.5" | K080675 | stock 90 mm | stock 70 mm | | 3.8 | 44% | 24,300 |
| | 2.38" 10 bolt | L220310709 | 67.5" | K080675 | stock 90 mm | stock 70 mm | | 4.0 | 54% | 26,000 |
| 10.0" L220380709 (28%) | stock 3.0" | - | 70.0" | K080700 | stock 90 mm | stock 70 mm | LPE (L220636509) | 3.3 | 28% | 21,700 |
| | 2.55" press-on | L220030709 | 68.5" | K080685 | stock 90 mm | stock 70 mm | | 3.9 | 51% | 25,500 |
| | 2.55" 10 bolt | L220300709 | 68.5" | K080685 | stock 90 mm | stock 70 mm | | 3.9 | 51% | 25,500 |
| | 2.38" 10 bolt | L220310709 | 68.5" | K080685 | stock 90 mm | stock 70 mm | | 4.2 | 62% | 27,300 |
| 9.73" 10 rib L220450709 (requires 10 rib tensioner pulley) | 2.70" 10 rib | XX03873-0004 | 67.5" | K100675 | LPE 76 mm, 0.350" spacer, M10x1.5x60mm cap head screw | LPE 76 mm, 0.200" spacer, M10x1.5x60mm cap head screw | LPE (L220636509) | 3.5 | 35% | 22,800 |

Supercharger speeds above 23,000 RPM are not recommended. To calculate supercharger speed, multiply your maximum engine speed by the pulley ratio value listed above.

Pulley ratios above 35% should only be used in applications with proportionally lower maximum engine speeds (below 6500 RPM).

For applications where the crank pulley diameter is greater than or equal to 9.17", LPE idler relocation bracket (PN: L220636509) is required in order to provide enough clearance between the crank pulley and the lower idler pulley. For bearing durability reasons LPE does not recommend using idler pulleys smaller than 70mm.

An LPE idler pulley is required for these pulley/belt combinations.

Notes

LINGENFELTER

PERFORMANCE ENGINEERING



LPE is also an Authorized Distributor for:

- AAM
- ACS
- ATI
- Bilstein
- Callies
- Comp Cams/FAST
- Corsa
- Driveshaft Shop
- Edelbrock
- JE Pistons
- Magnuson
- Mahle
- Manley
- Oliver
- PAC Racing Springs
- Setrab
- TI Automotive / Walbro
- Total Seal
- and many others

Lingenfelter Performance Engineering
1557 Winchester Road
Decatur, IN 46733
(260) 724-2552
(260) 724-8761 fax
www.lingenfelter.com

